

NEXO

L I G H T I N G

Installation

MULTI TRACK SYSTEM

info@nexolighting.com

+971522567107

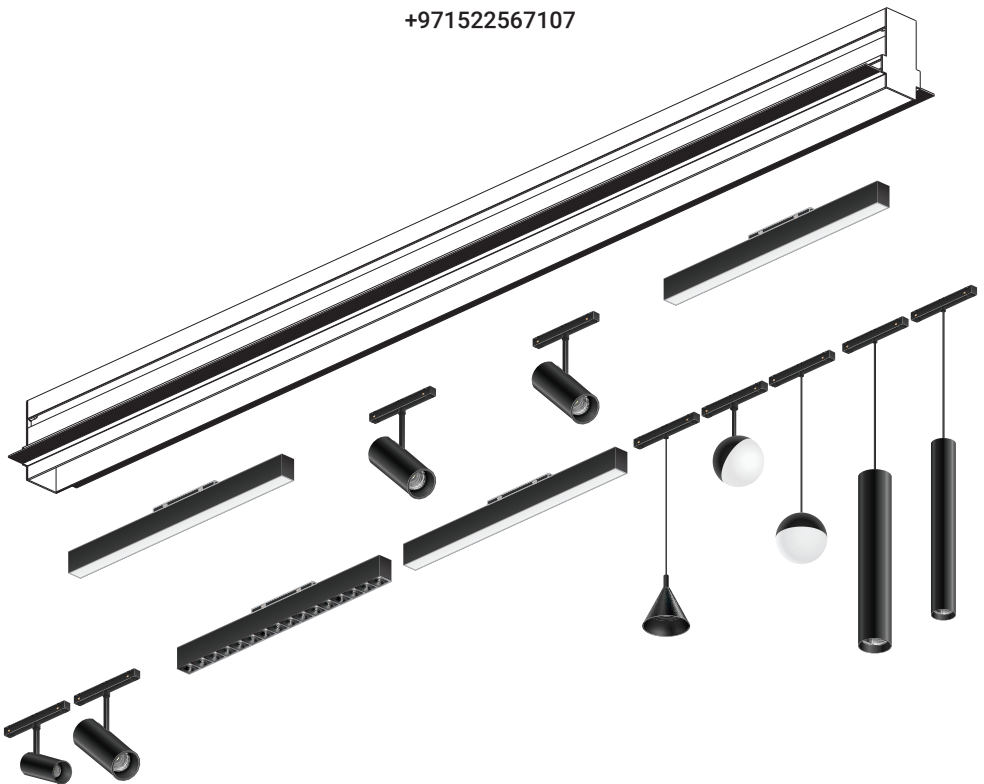





<https://nexolighting.com/multitrack>

NEXO has integrated lighting with architecture to design high-quality and uniquely styled products. All products are tested under resistant and standard conditions to ensure longevity without special maintenance. A 5-year warranty is provided under the terms specified in the warranty certificate.

 Dubai, United Arab Emirates

 info@nexolighting.com

 +971522567107

Warnings



Installation and use must be performed only by a qualified technician.



Power must be disconnected before installation. Follow international and safety standards.



All products include a -5year warranty covering component and light quality.



The manufacturer is not responsible for damage caused by improper installation or usage.



Only the manufacturer, their representatives, or certified personnel may replace or modify the light source.



A separate electrical panel with full protection systems must be used for power supply, especially in areas with heavy motor loads.



Avoid compressing or striking the product during transport and storage.



During construction work like welding, lights must be off or stabilized to avoid damaging the driver or electrical components.



Do not touch the LED module directly or strike it.



The fixture must only be powered through its provided driver; using a different driver or direct power connection may cause damage.



No need for drilling, cutting, or modifying the electrical system.



The low-voltage lighting system does not require a grounding connection to the driver.



For more information, contact NEXO after-sales service.

System Description:

- ➔ Magnetic track lights represent one of the latest and most advanced technologies in the lighting industry. They attach magnetically to the track, allowing for easy repositioning and flexible lighting adjustments at any time. Thanks to their high versatility, magnetic lights can be effortlessly moved to match changes in space layout or function. You can even add new light sources to the system, enabling you to achieve your desired lighting design with ease.

Features of Magnetic Track Lights:

- ➔ **High Flexibility:**
Thanks to the magnetic connection, magnetic lights can be easily repositioned or replaced. You can modify the lighting layout to match spatial changes without any need for rewiring.
- ➔ **Easy Installation:**
With a simple click, the light fixture attaches magnetically to the track—quick and hassle-free.
- ➔ **High Safety:**
The system operates at a low voltage of 48V, ensuring a completely safe and shock-free lighting solution.
- ➔ **Low Energy Consumption:**
Equipped with energy-efficient LEDs, magnetic lights consume less power and have a longer lifespan.
- ➔ **Variety of Models and Applications:**
Magnetic lights are available in various styles—such as spotlights, linear lights, and decorative fixtures—making them suitable for a wide range of applications.

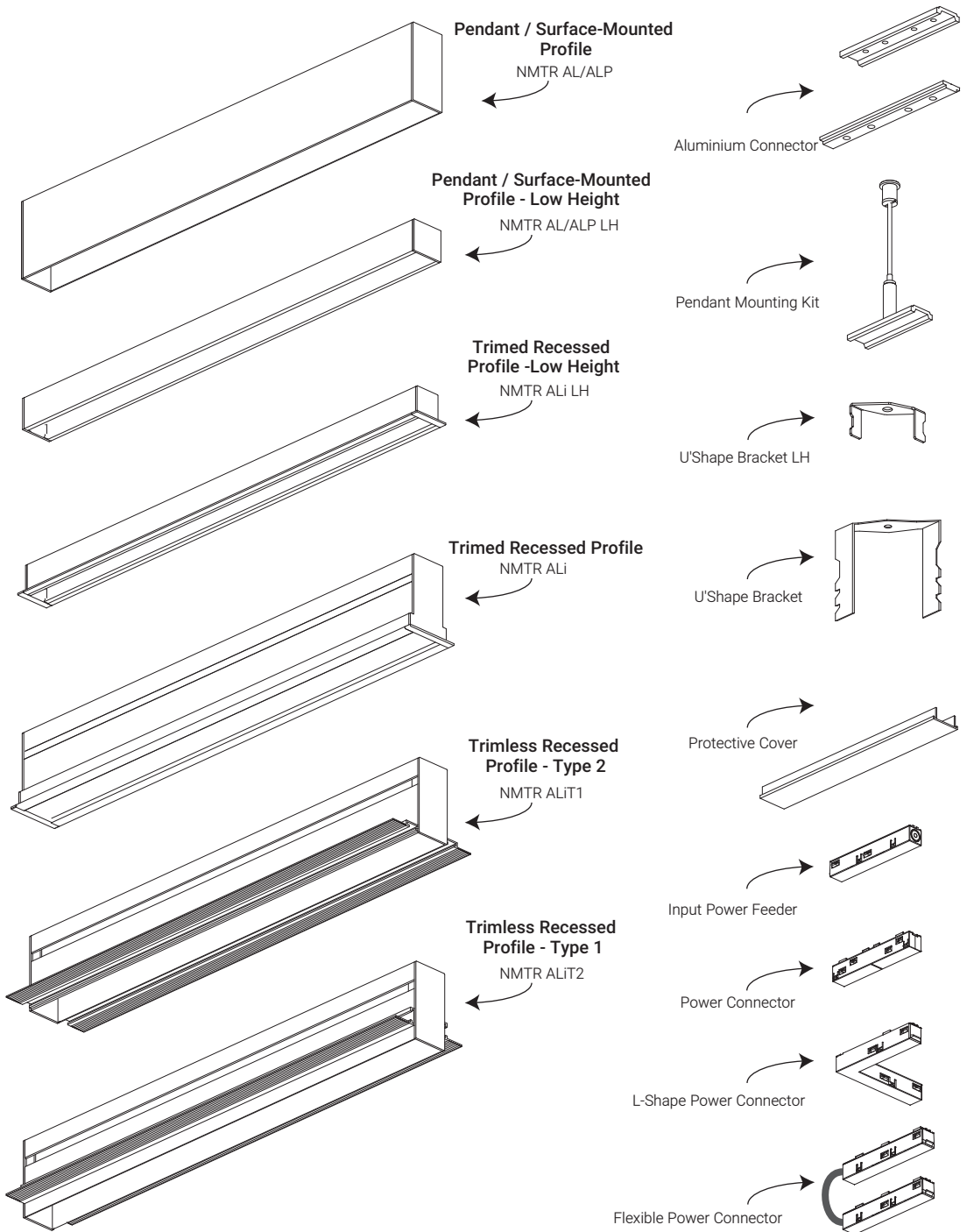

Installation of Trimless Recessed Profile (Type 2 / Section View)

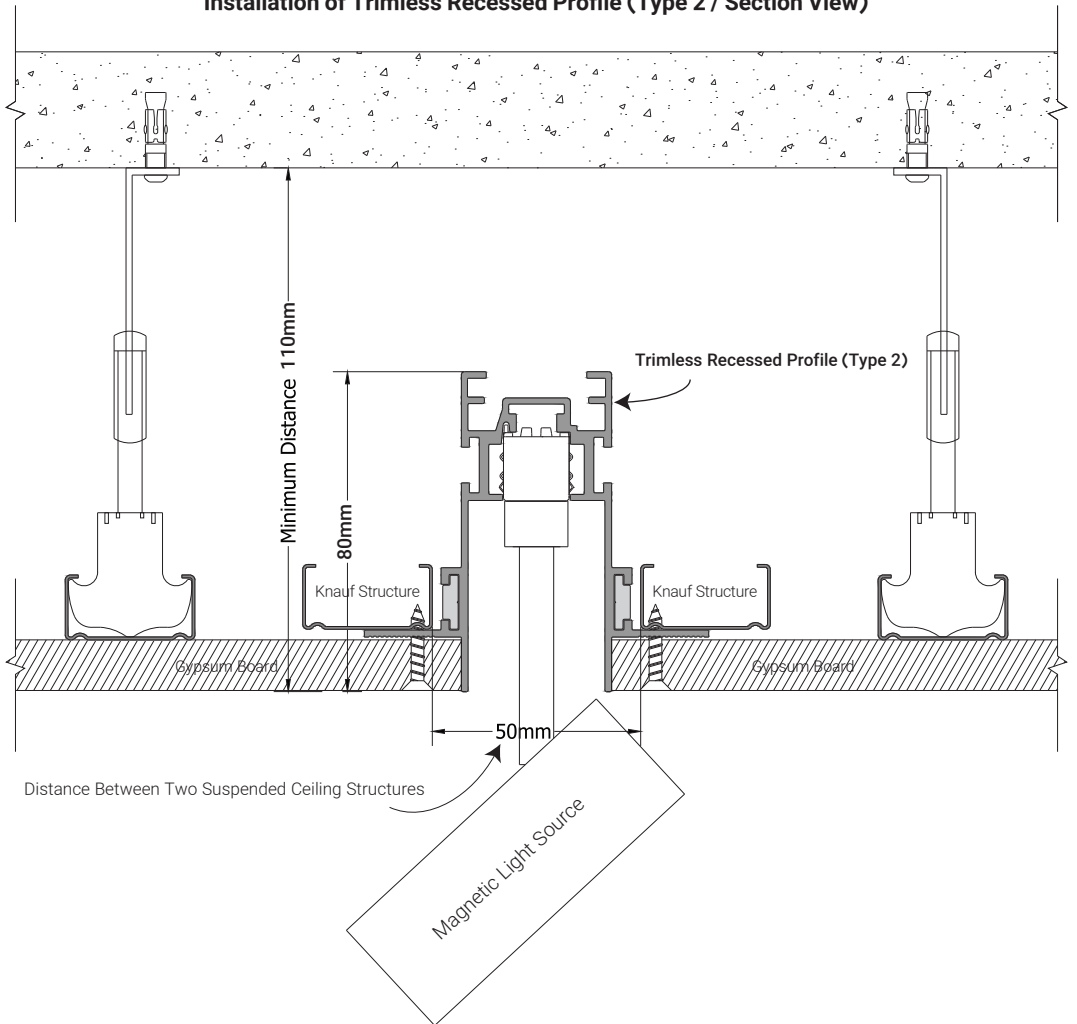

On-site cutting is permitted only with the manufacturer's approval.

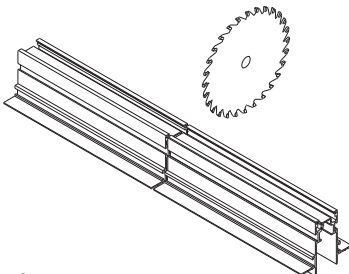

Do not remove the protective cover until final installation of the profile is completed.

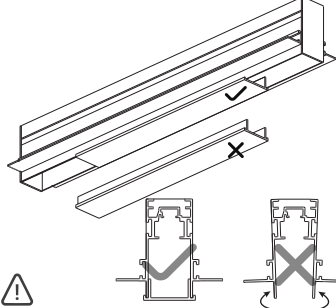

Do not connect 220V power directly to the Profile input (feeder).

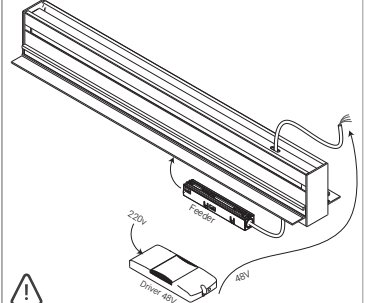

Installation of Trimless Recessed Profile (Type 2 Profile / Structure Installation)

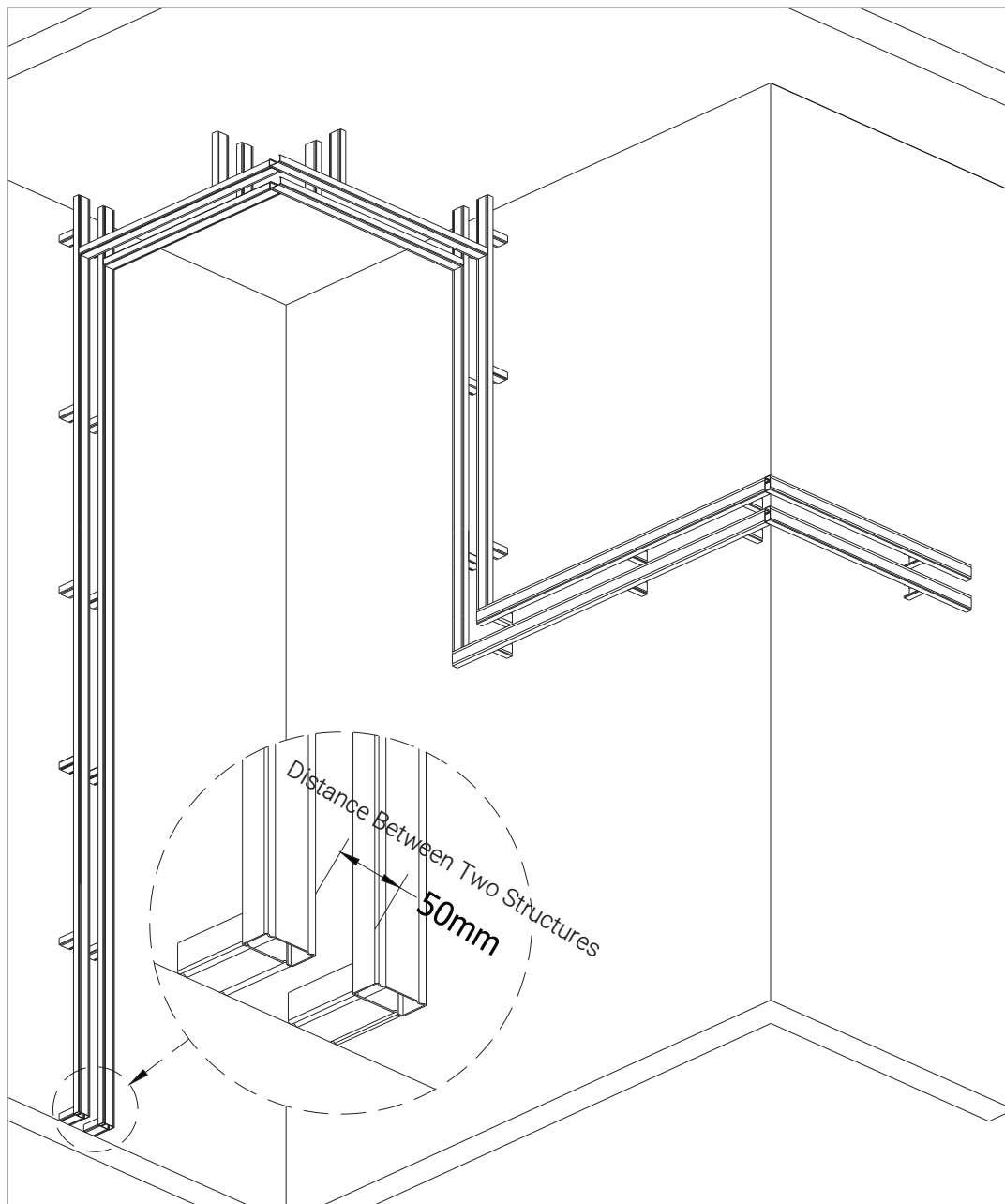

Installation of Trimless Recessed Profile (Type 2 / Profile Installation)

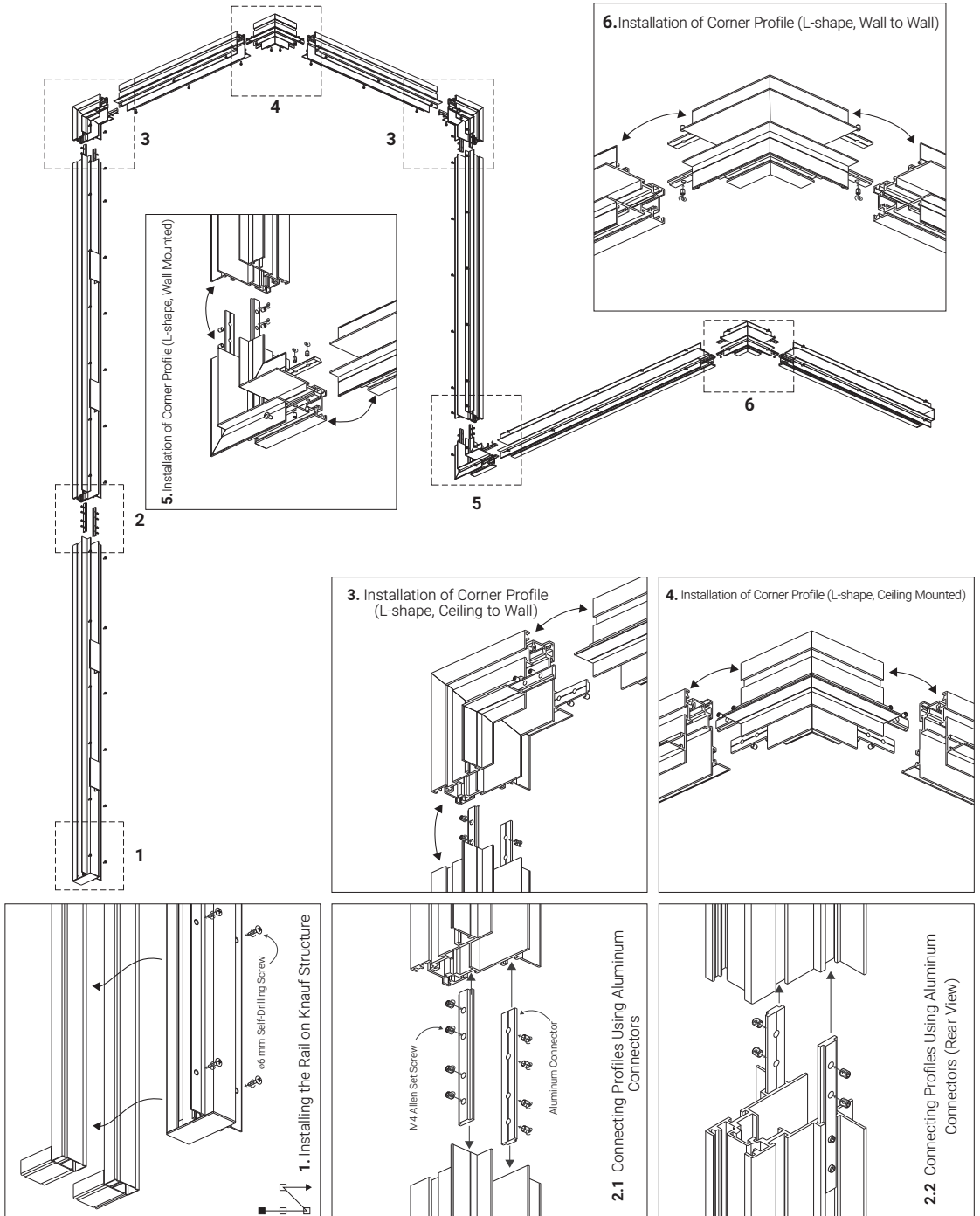

Installation of Trimless Recessed Profile (Type 2 / Electrical Connections and Gypsum Board Installation)

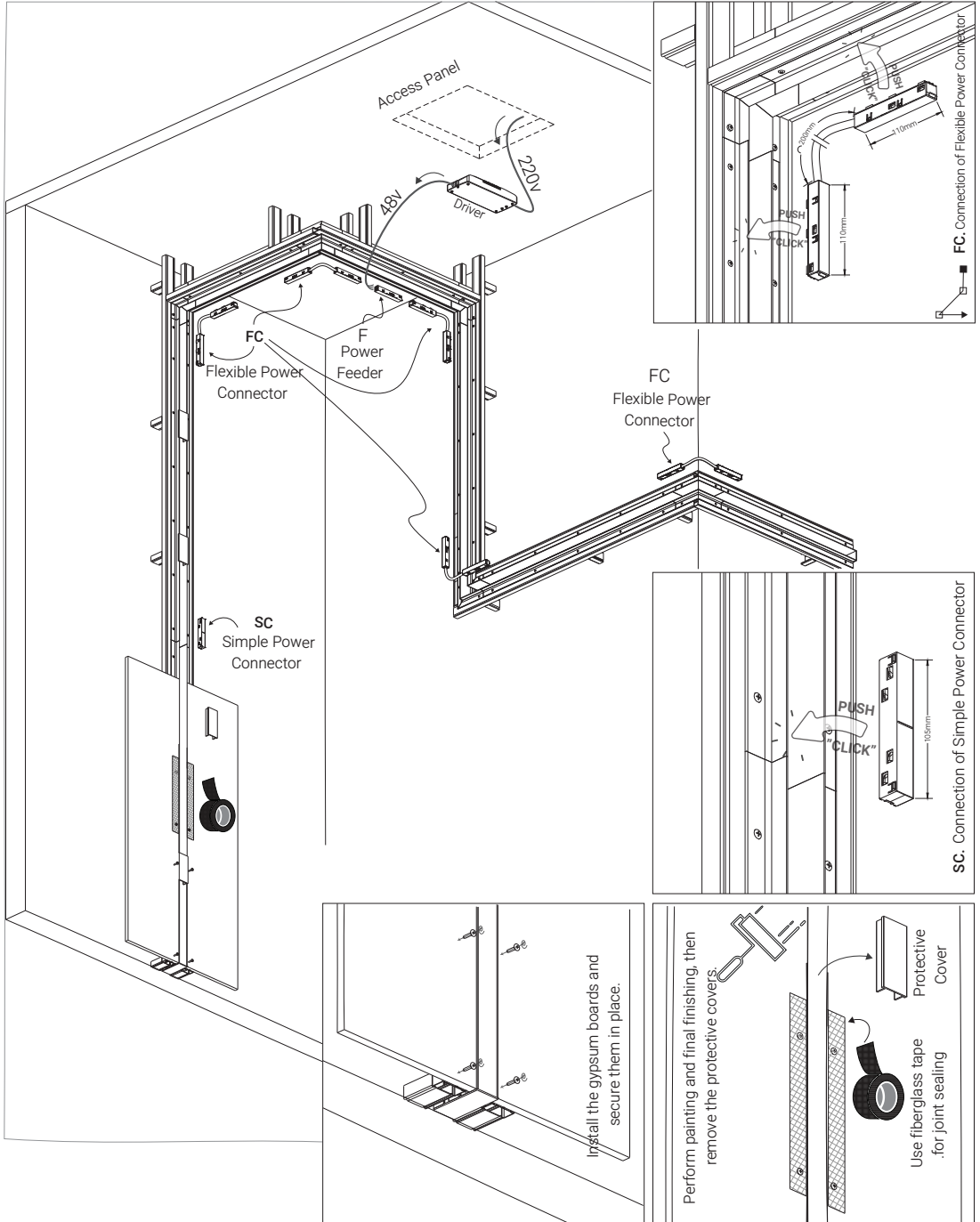

Installation of Trimless Recessed Profile (Type 2 / Feeder Installation)

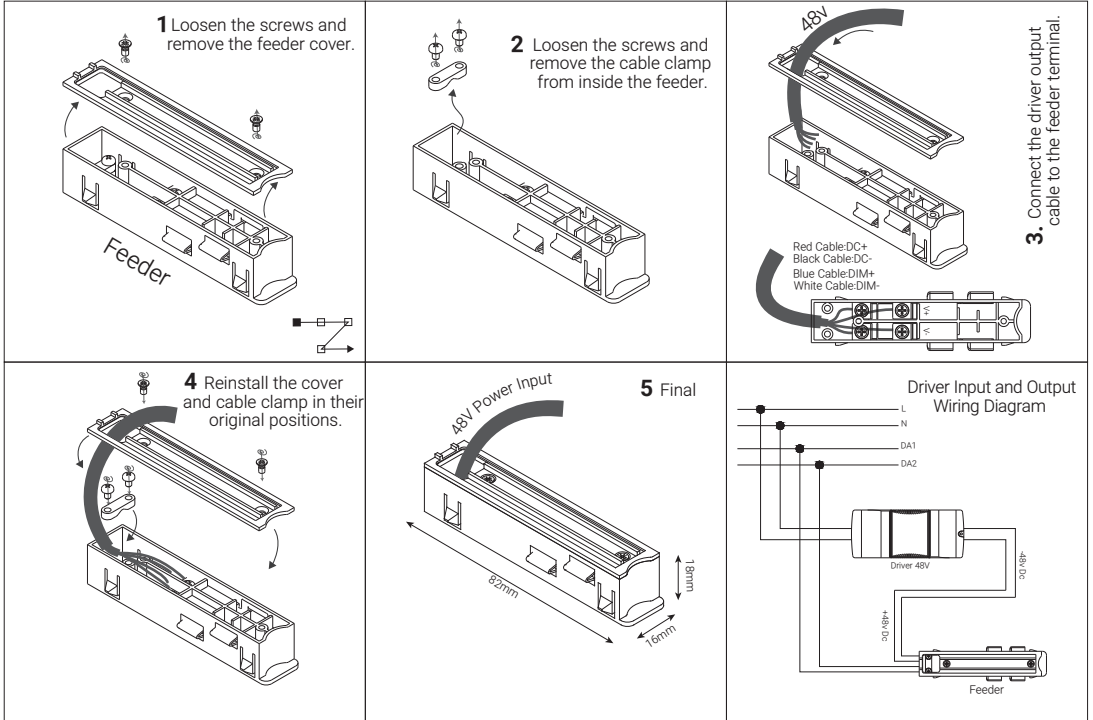

Method of Connecting the Power Supply Cable to the Rail via the Feeder

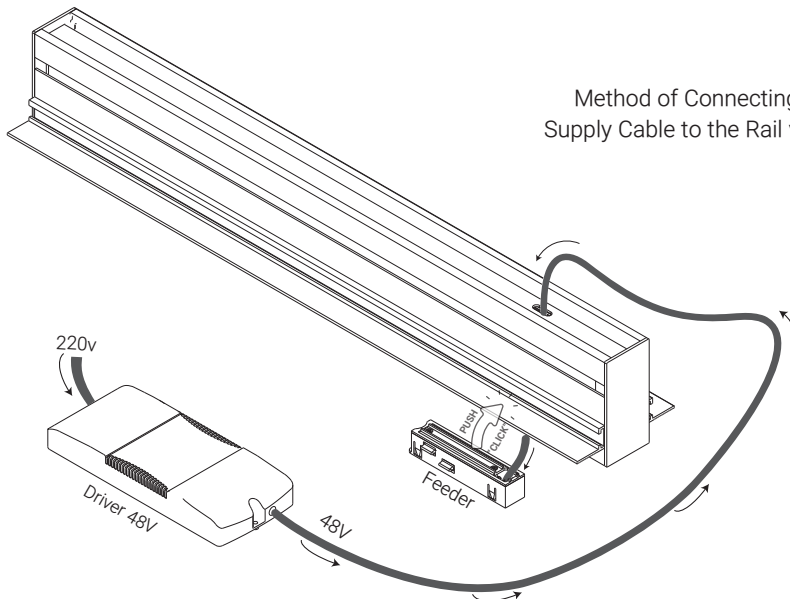

Installation of Trimless Recessed Profile (Type 1 / Section View)

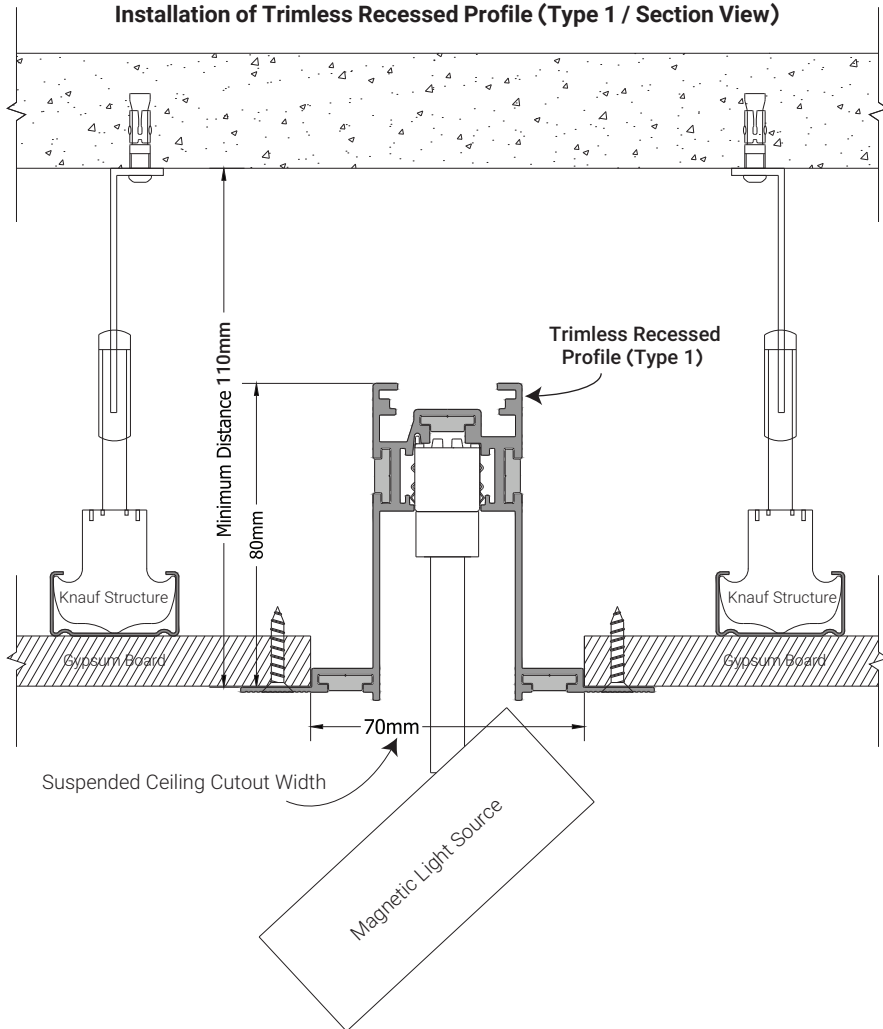

On-site cutting is permitted only with the manufacturer's approval.

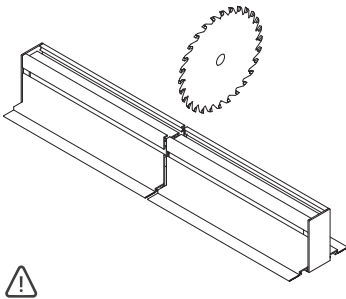

Do not remove the protective cover until final installation of the profile is completed.

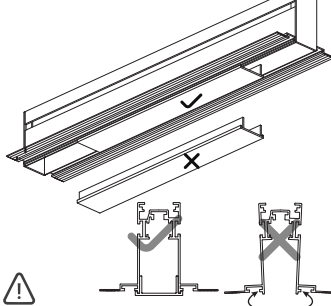

Do not connect 220V power directly to the Profile input (feeder).

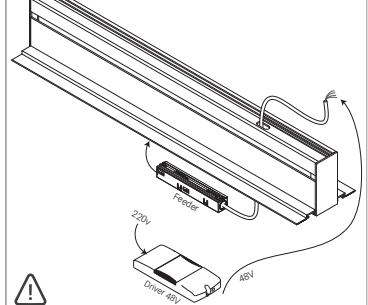

Installation of Trimless Recessed Profile (Type 1 / Substructure Installation)

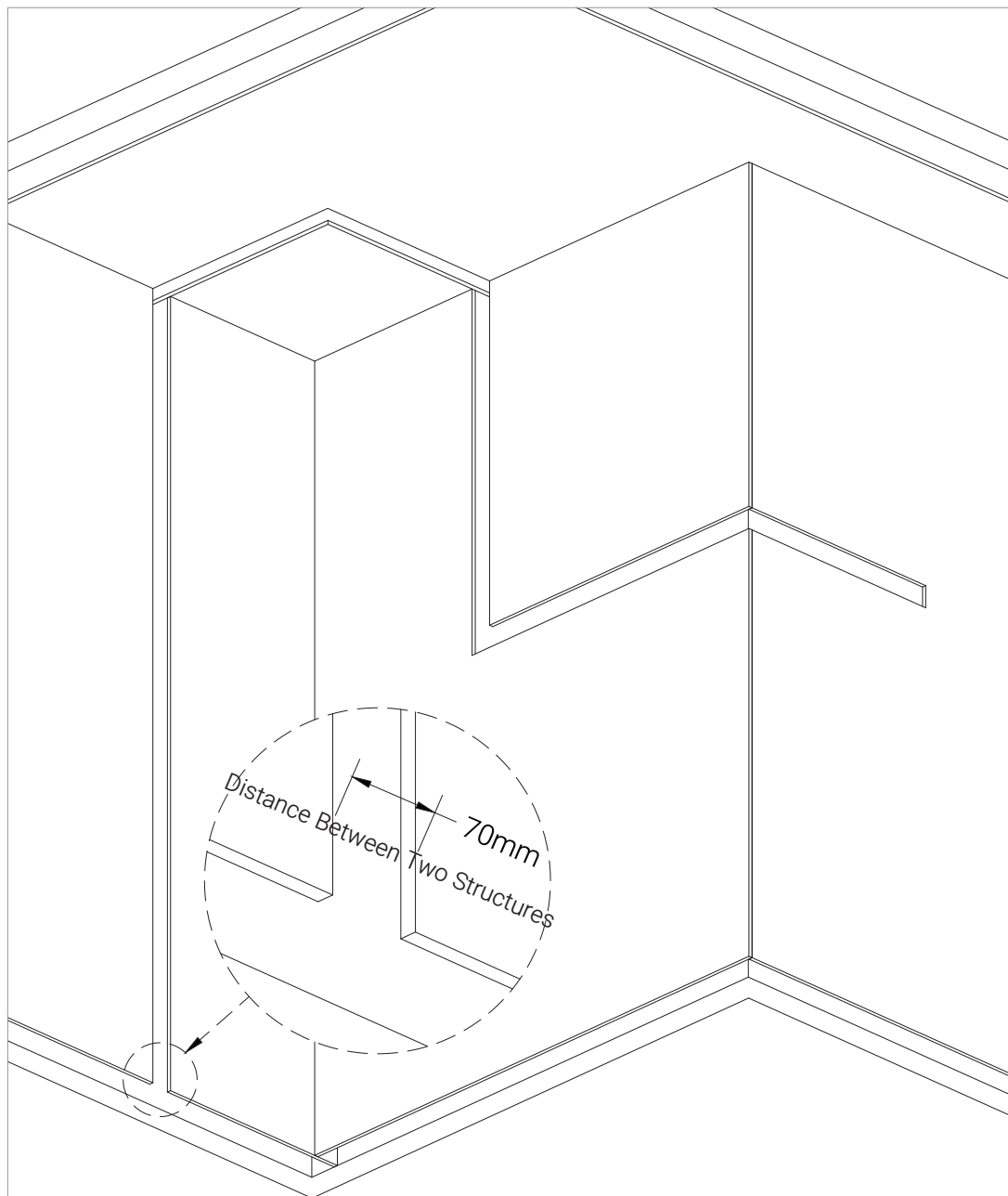

Installation of Trimed Recessed Profile (Standard / Profile Installation)

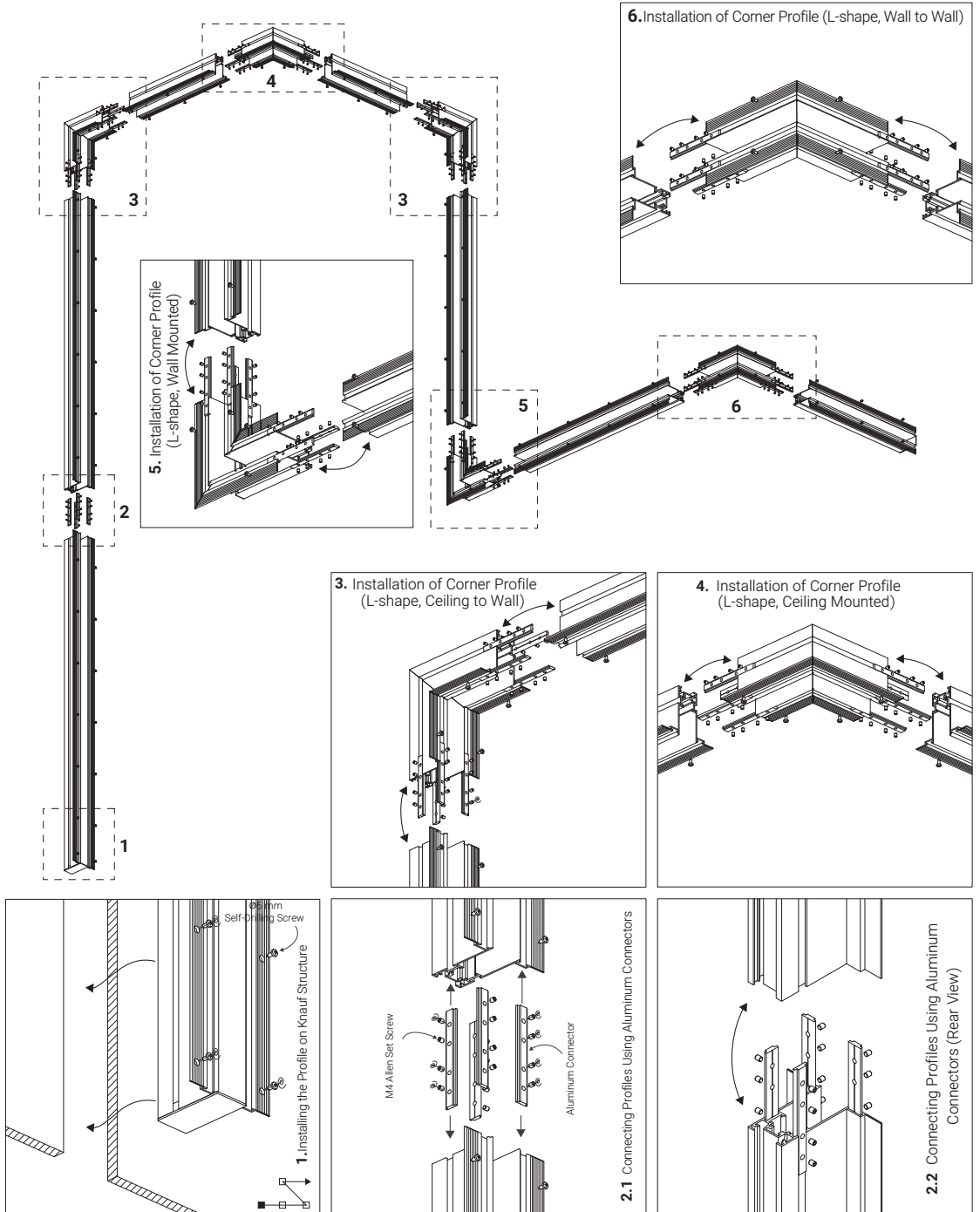

Installation of Trimless Recessed Profile (Type 1 / Electrical Connections Installation)

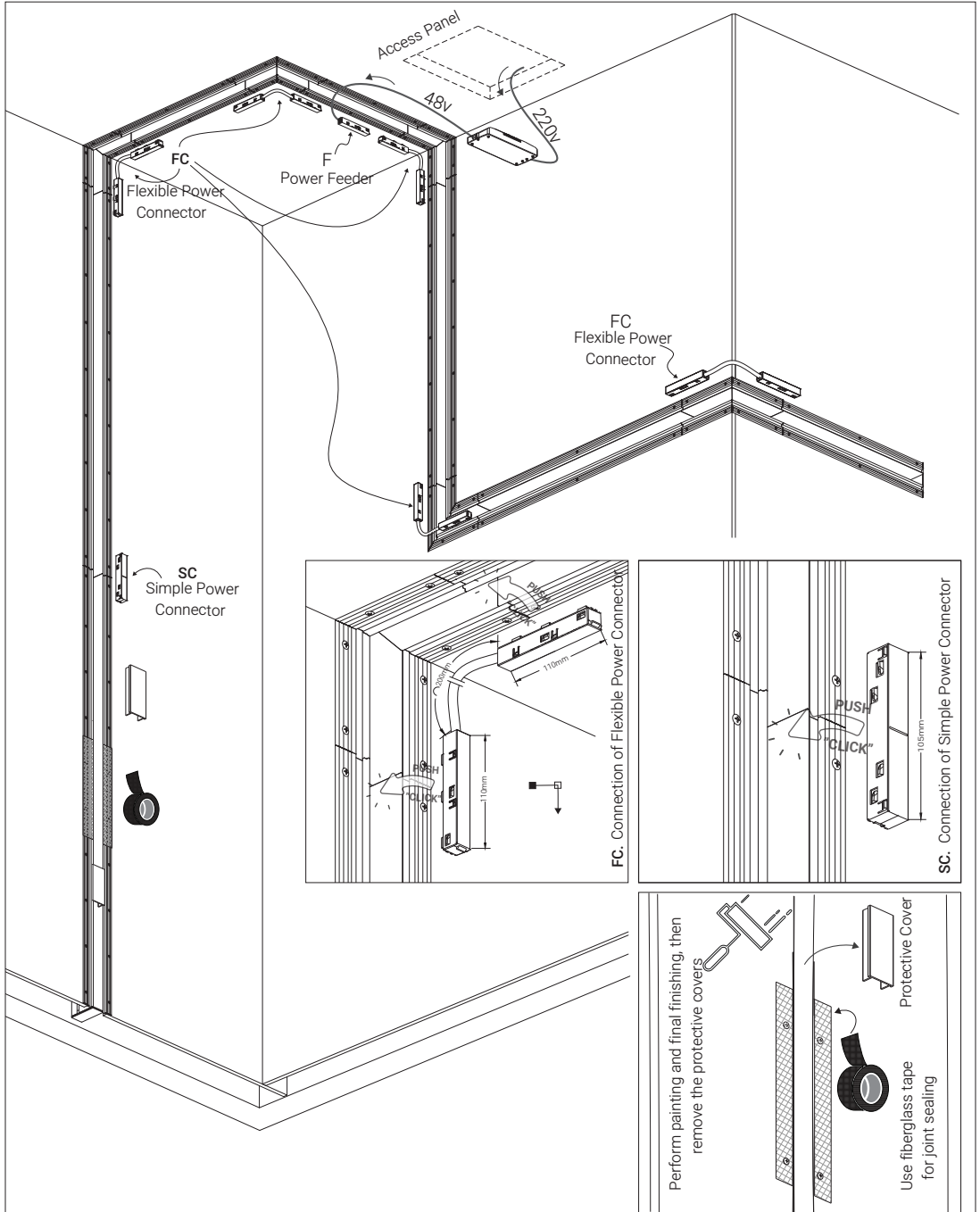

Installation of Trimless Recessed Profile (Type 1 / Feeder Installation)

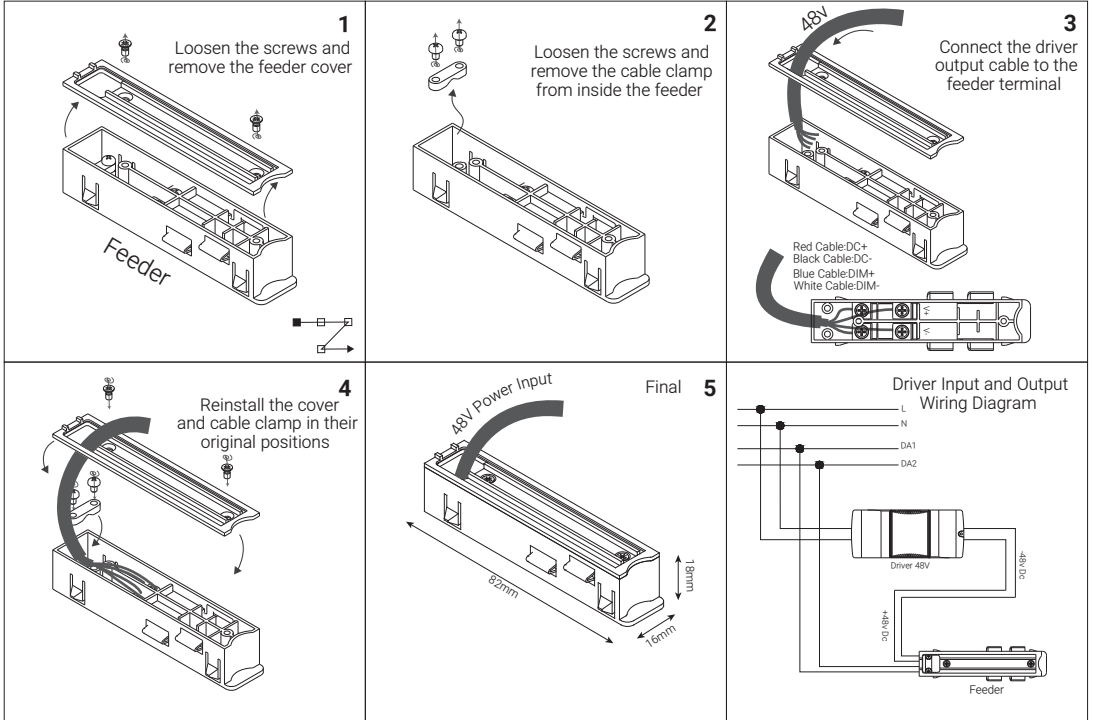

Method of Connecting the Power Supply Cable to the Rail via the Feeder

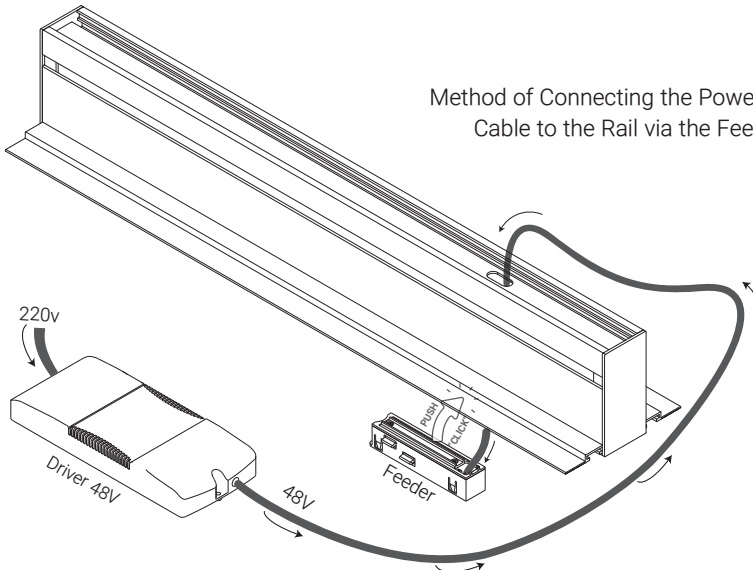

Installation of Trimmed Recessed Profile (Standard / Section View)

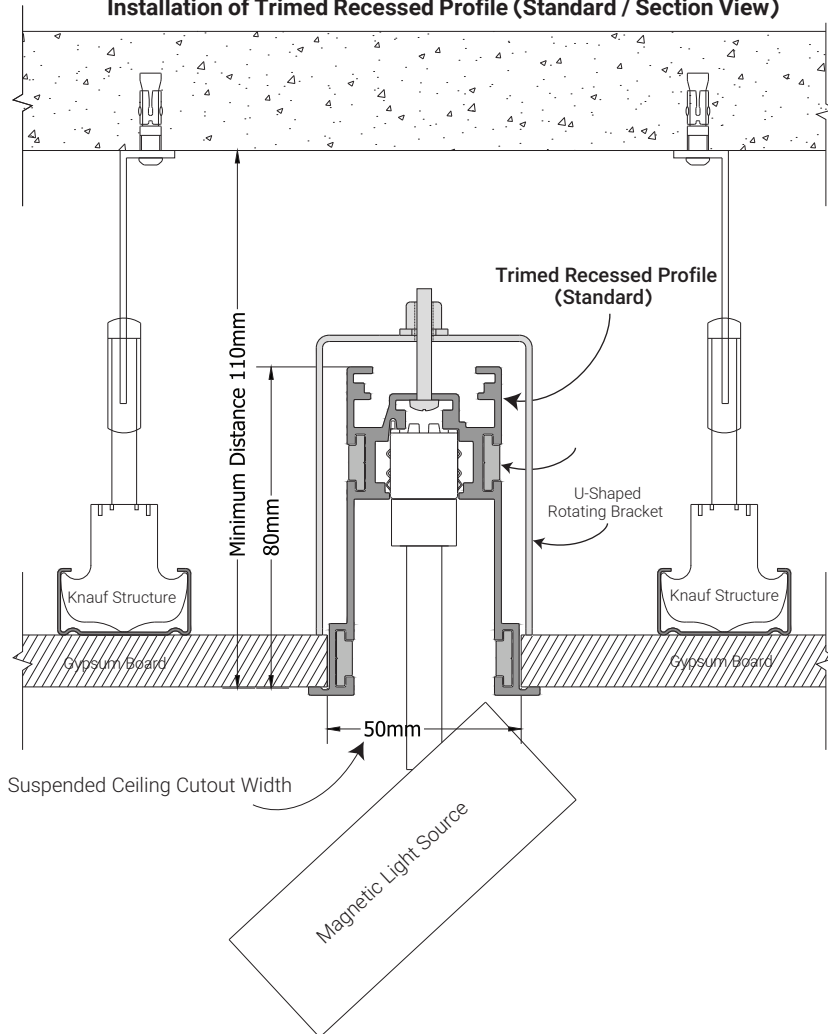

On-site cutting is permitted only with the manufacturer's approval.

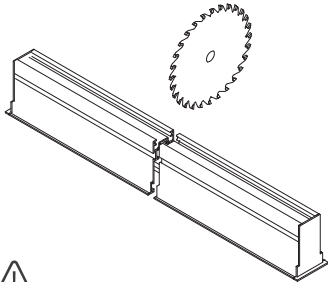

Do not remove the protective cover until final installation of the profile is completed.

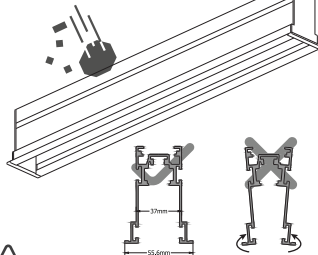

Do not connect 220V power directly to the Profile input (feeder).

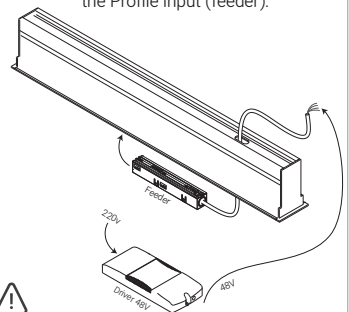

Installation of Trimmed Recessed Profile (Standard / Substructure Installation)

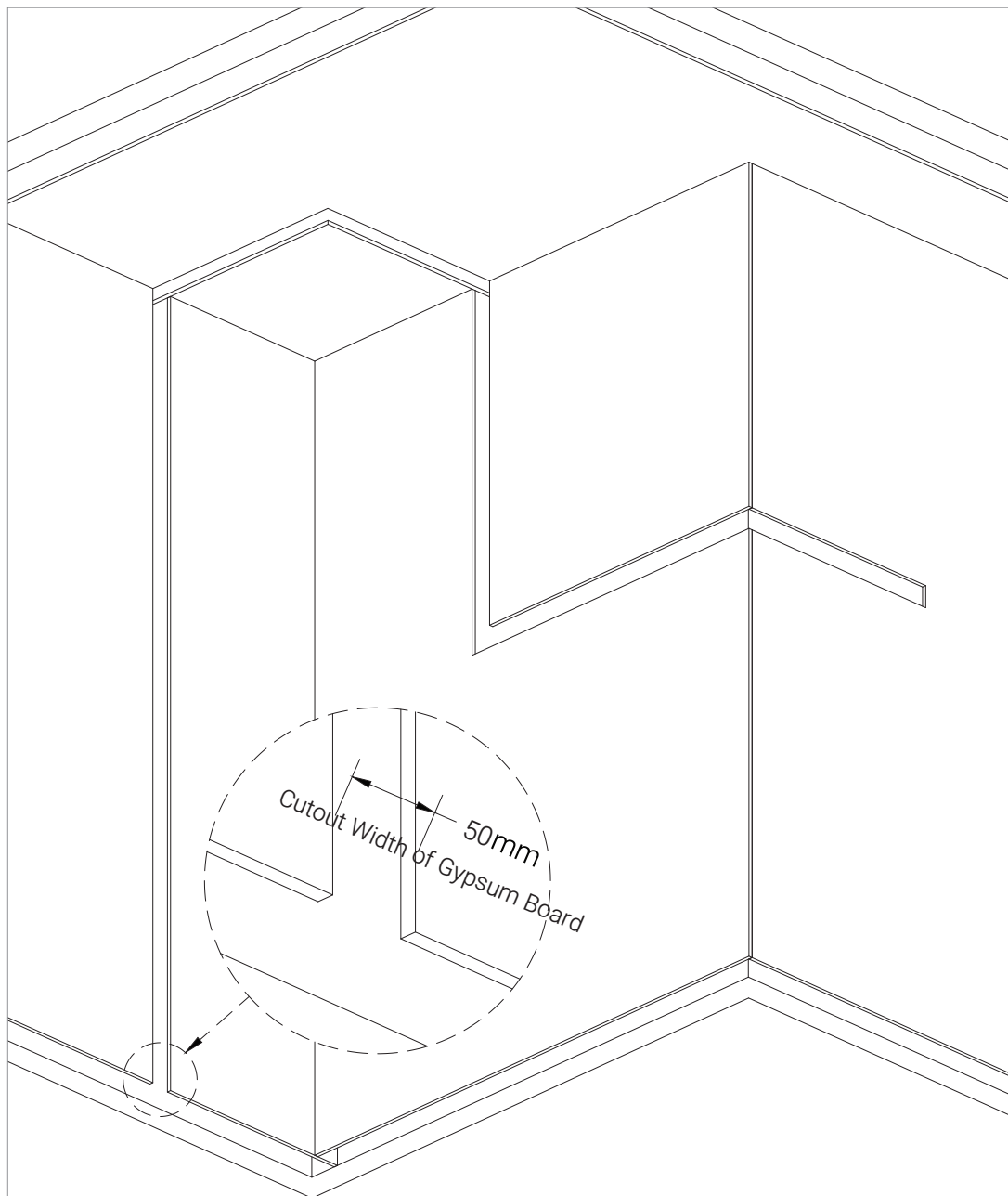

Installation of Trimed Recessed Profile (Standard / Profile Installation)

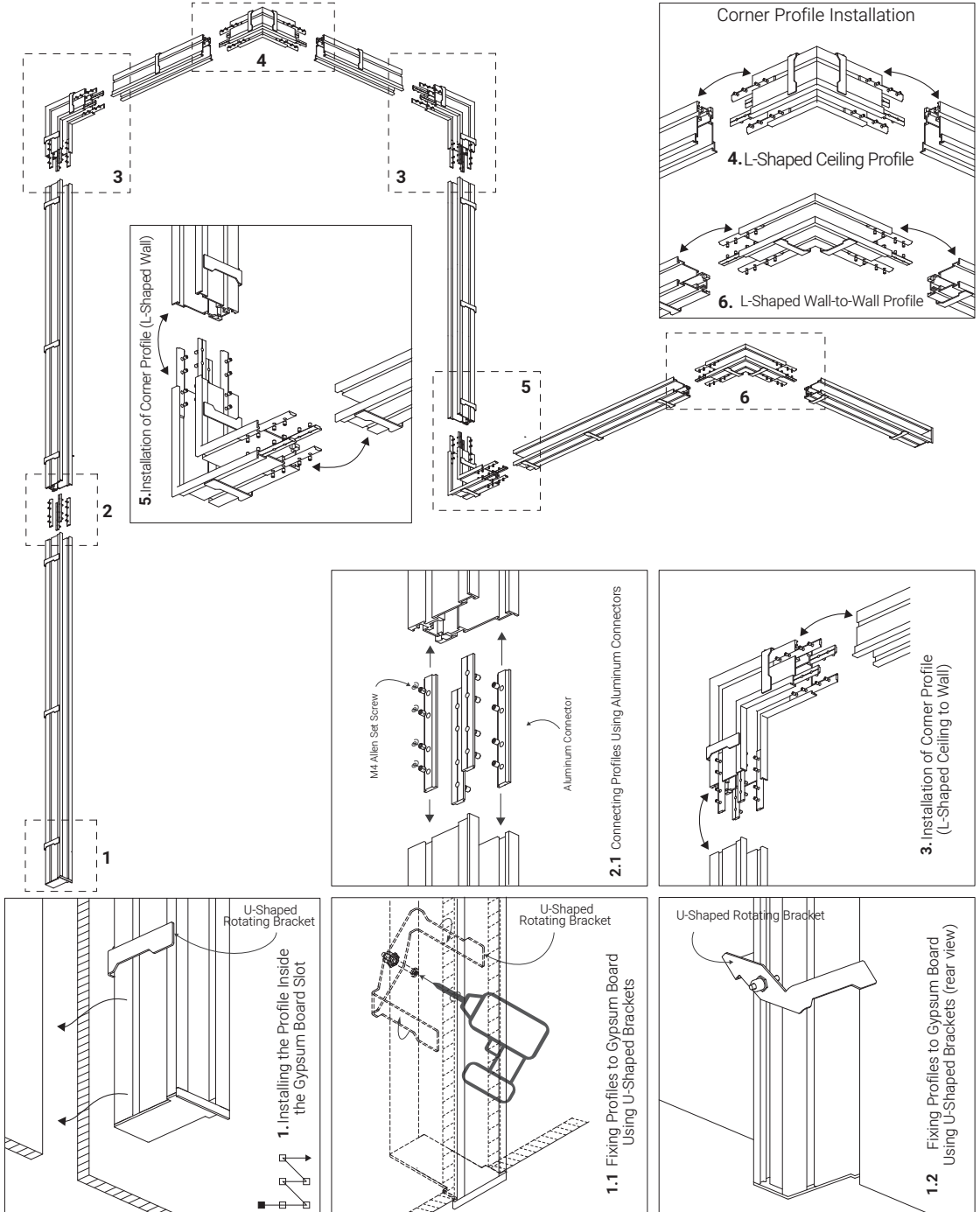

Installation of Trimmed Recessed Profile (Standard / Electrical Connections Installation)

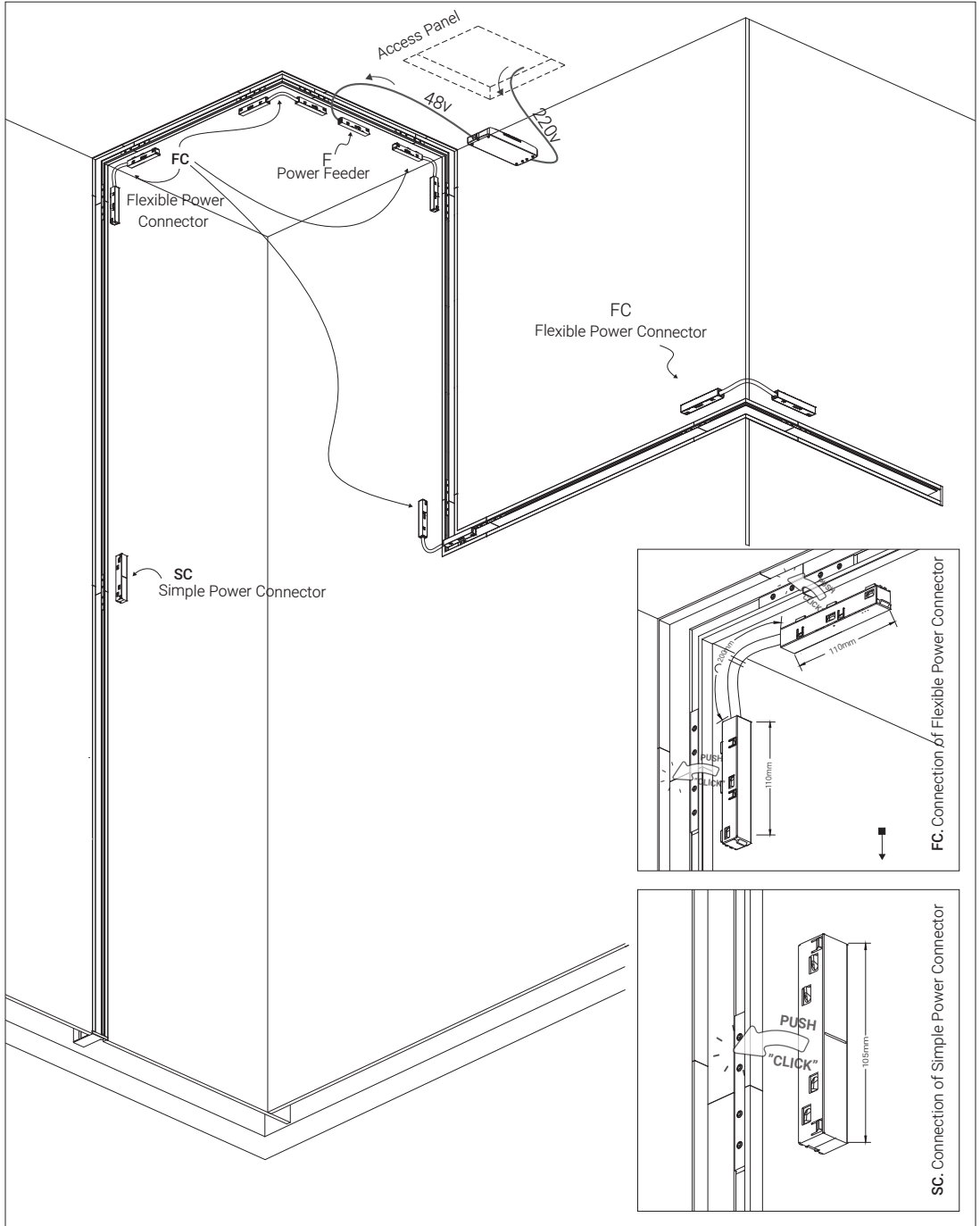

Installation of Trimed Recessed Profile (Standard / Feeder Installation)

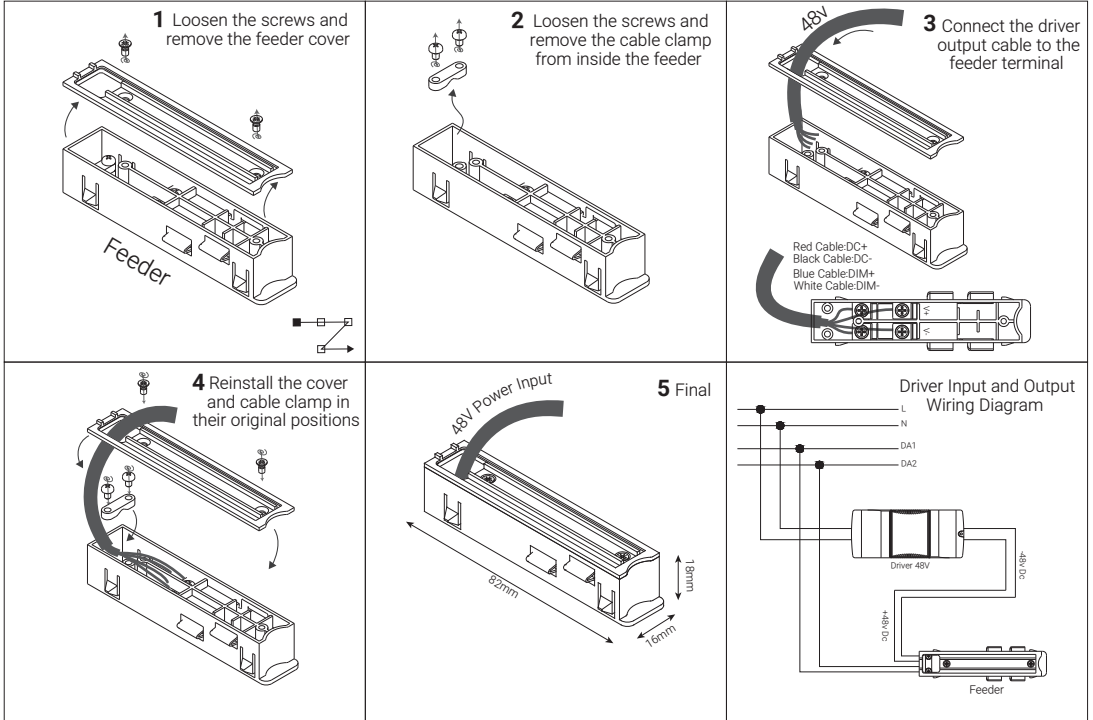

Method of Connecting the Power Supply Cable to the Rail via the Feeder

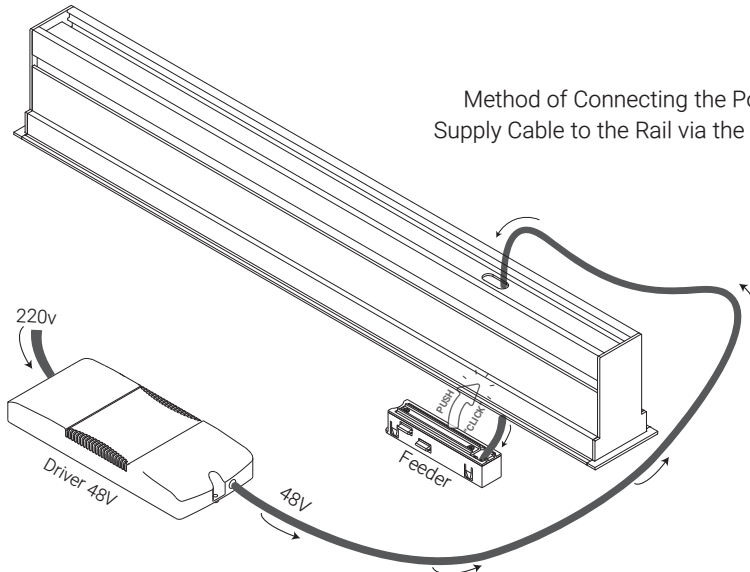

Installation of Trimmed Recessed Profile (Low Height / Section View)

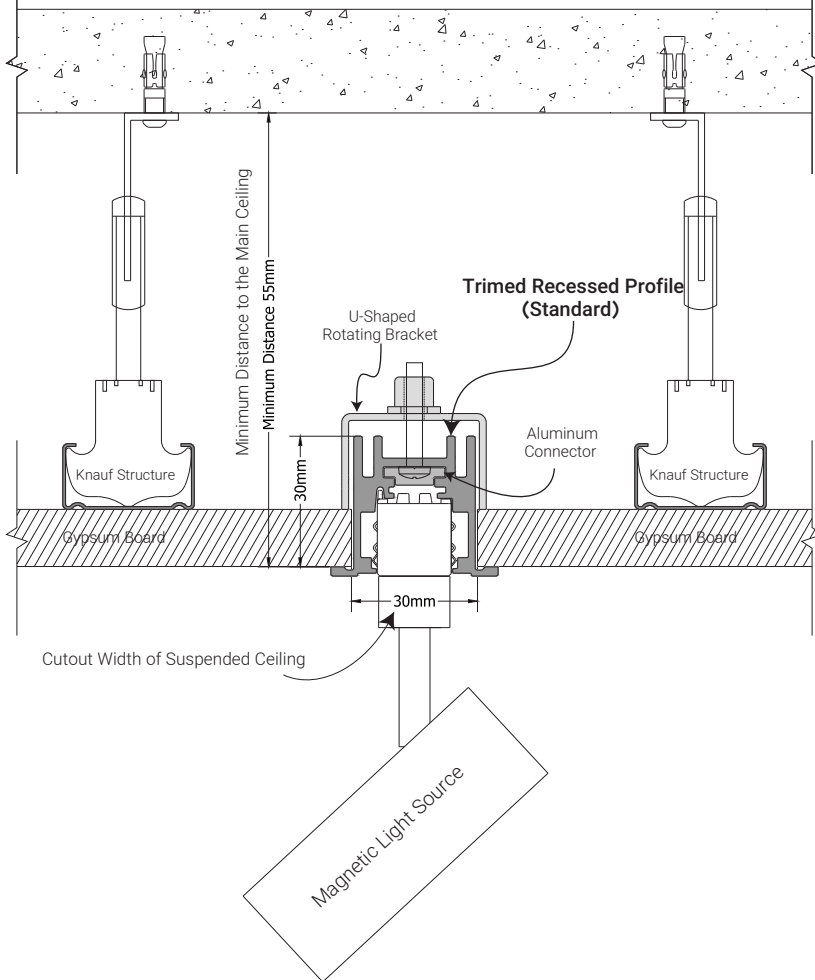

On-site cutting is permitted only with the manufacturer's approval.

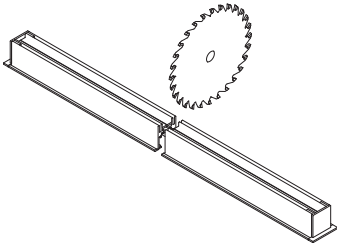

Do not remove the protective cover until final installation of the profile is completed.

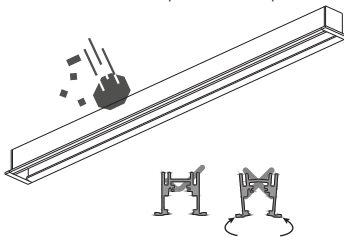

Do not connect 220V power directly to the Profile input (feeder).

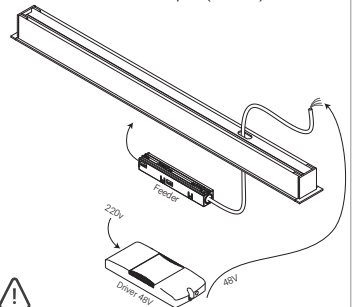

Installation of Trimmed Recessed Profile (Low Height / Substructure Installation)

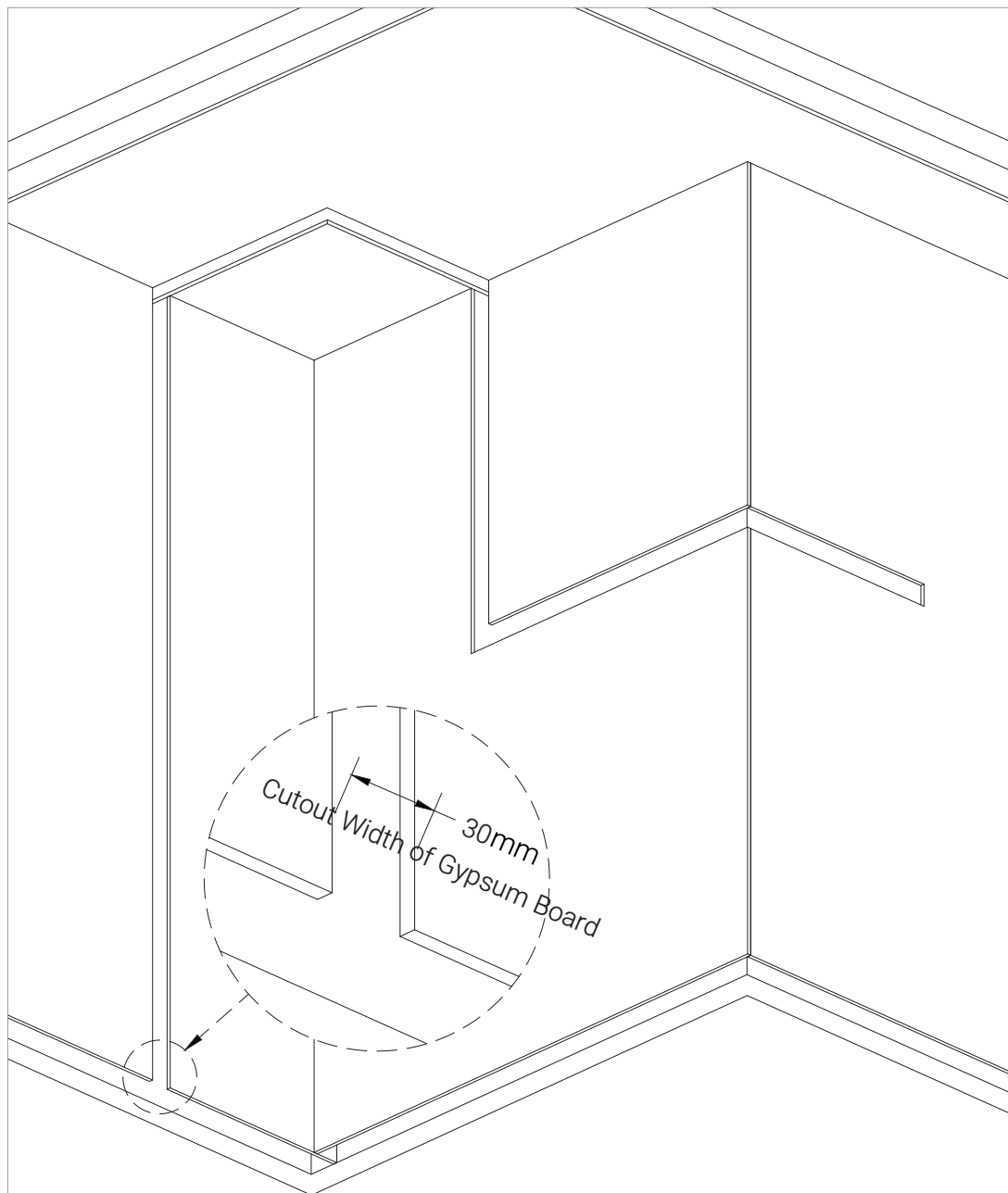

Installation of Trimmed Recessed Profile (Low Height / Profile Installation)

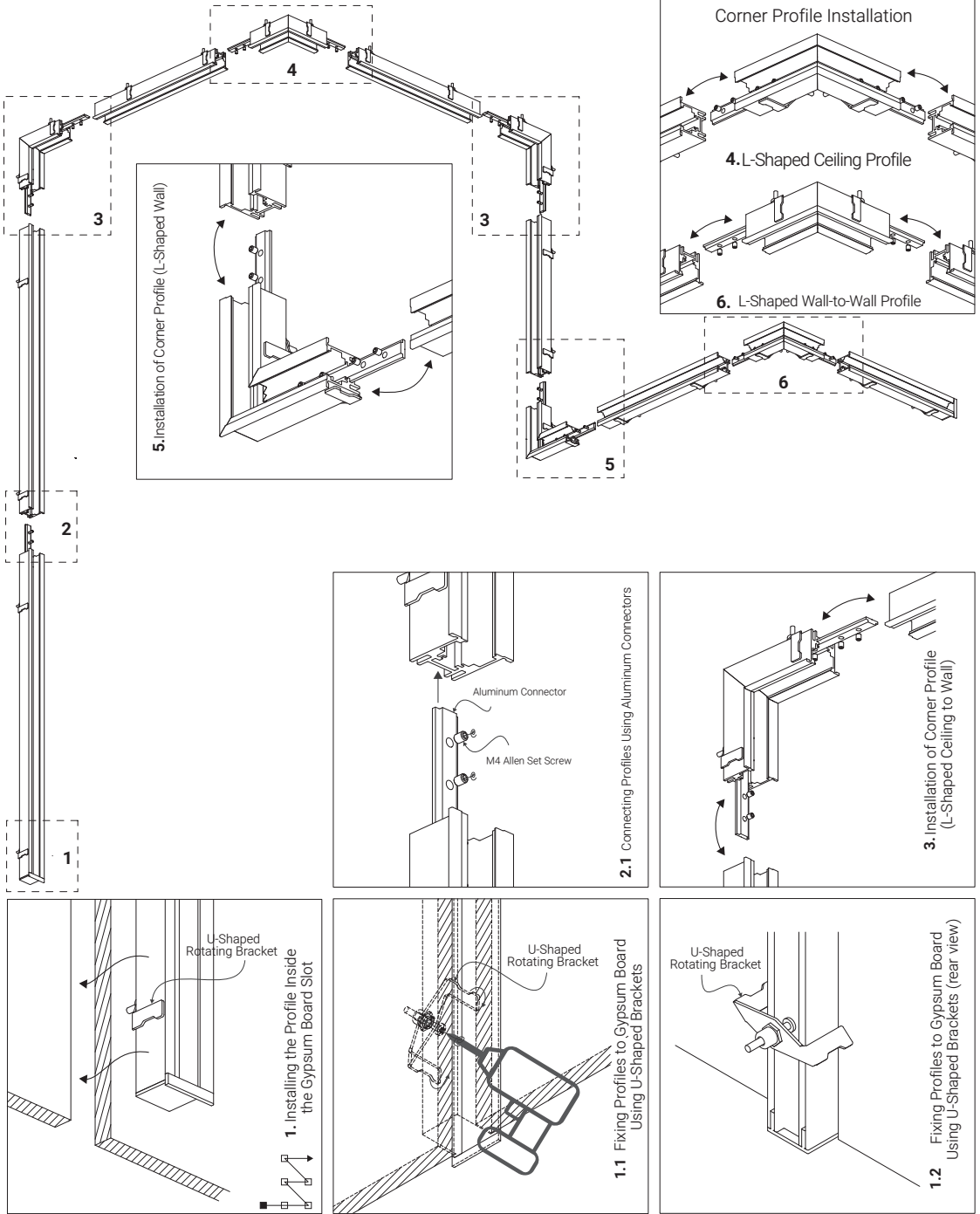

Installation of Trimmed Recessed Profile (Low Height / Electrical Connections Installation)

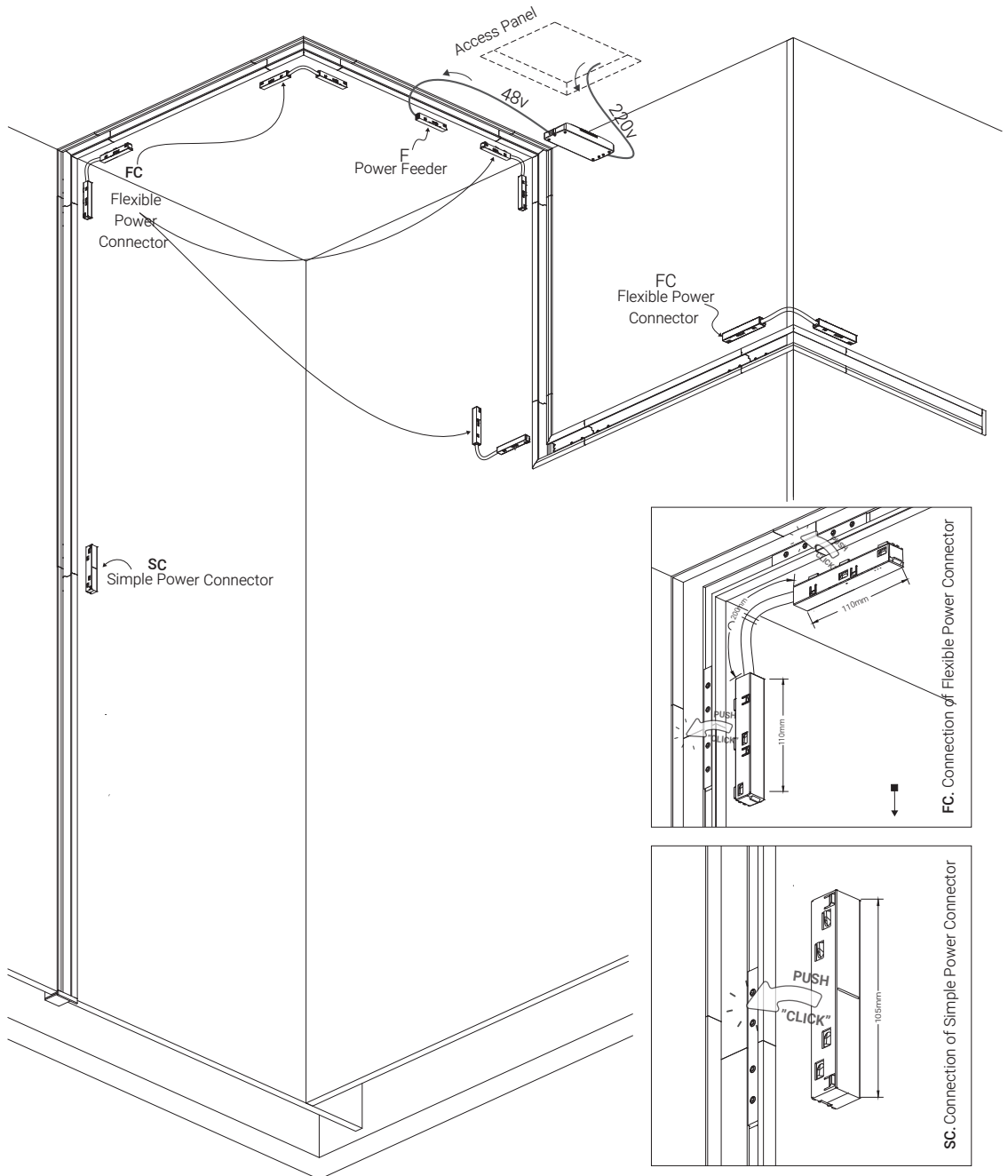

Installation of Trimmed Recessed Profile (Low Height / Feeder Installation)

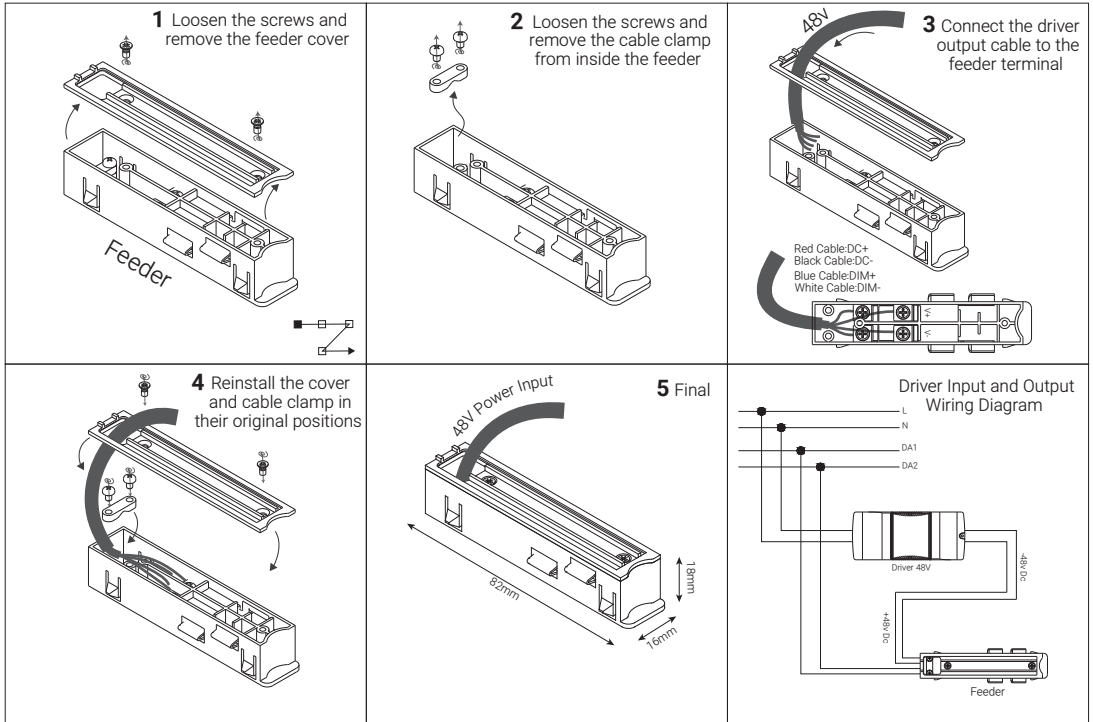

Method of Connecting the Power Supply Cable to the Rail via the Feeder

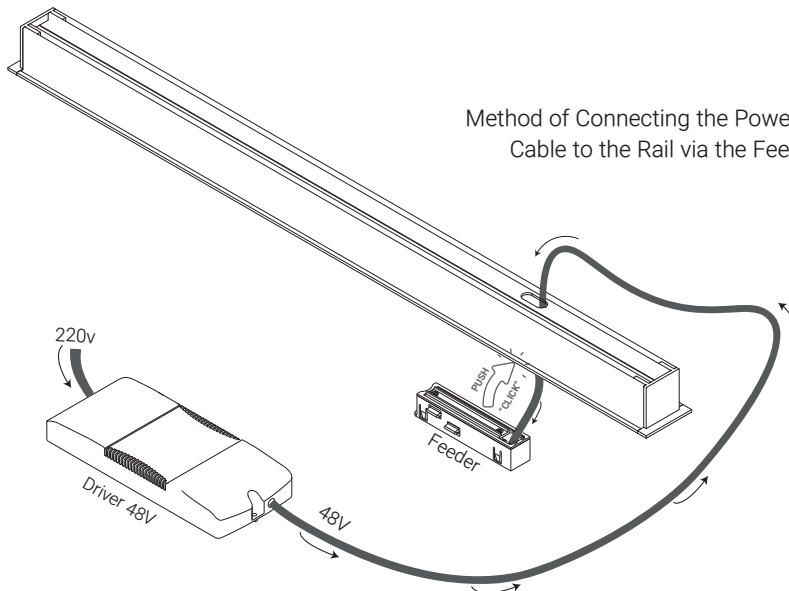

Installation of Surface-Mounted Profile (Low Height / Section View)

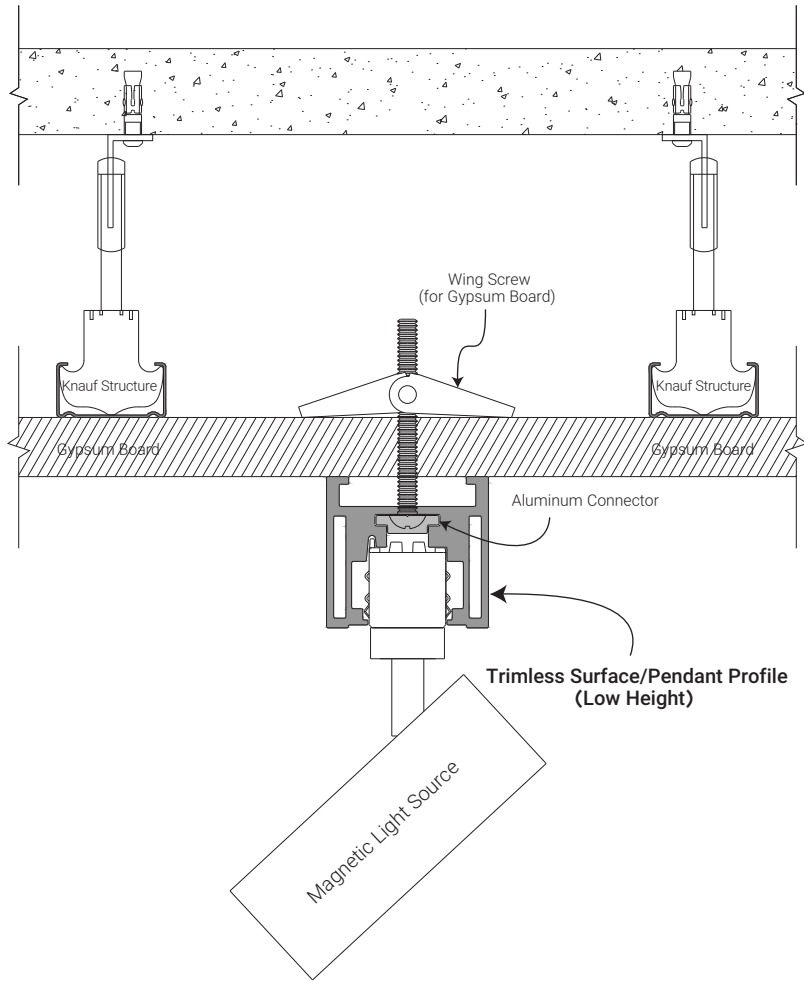

On-site cutting is permitted only with the manufacturer's approval.

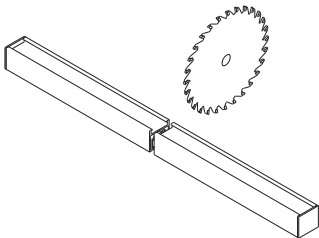

Do not remove the protective cover until final installation of the profile is completed.

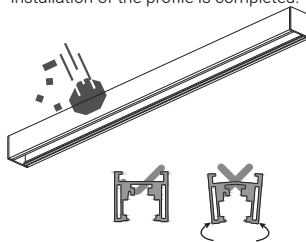

Do not connect 220V power directly to the Profile input (feeder).

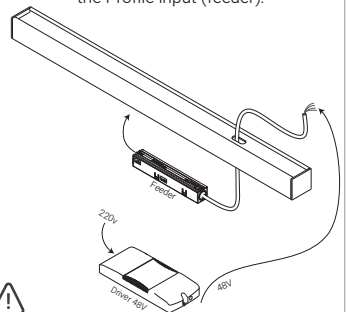

Installation of Surface-Mounted Profile (Low Height / Rail Installation)

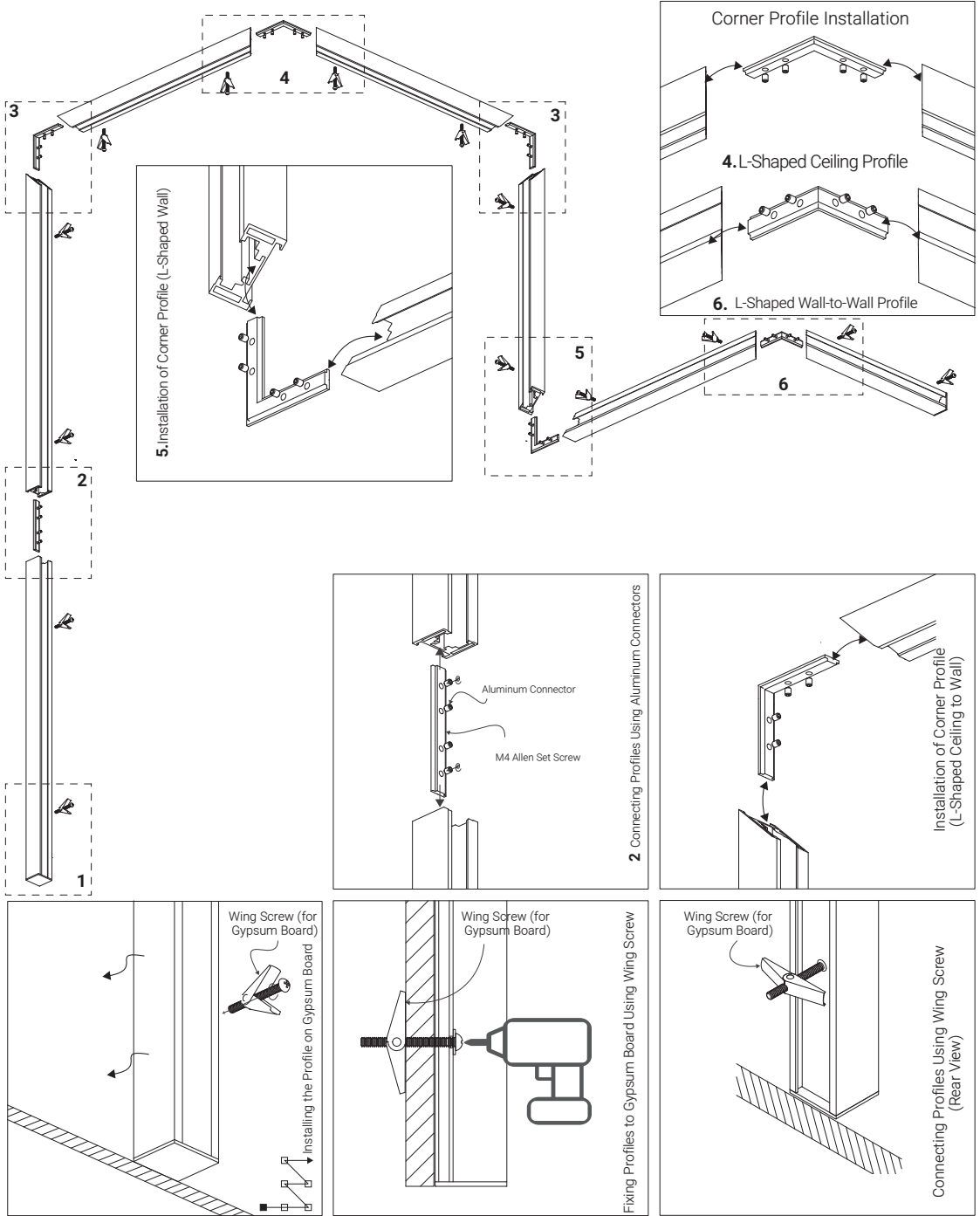

Installation of Surface-Mounted Profile (Low Height / Electrical Connections Installation)

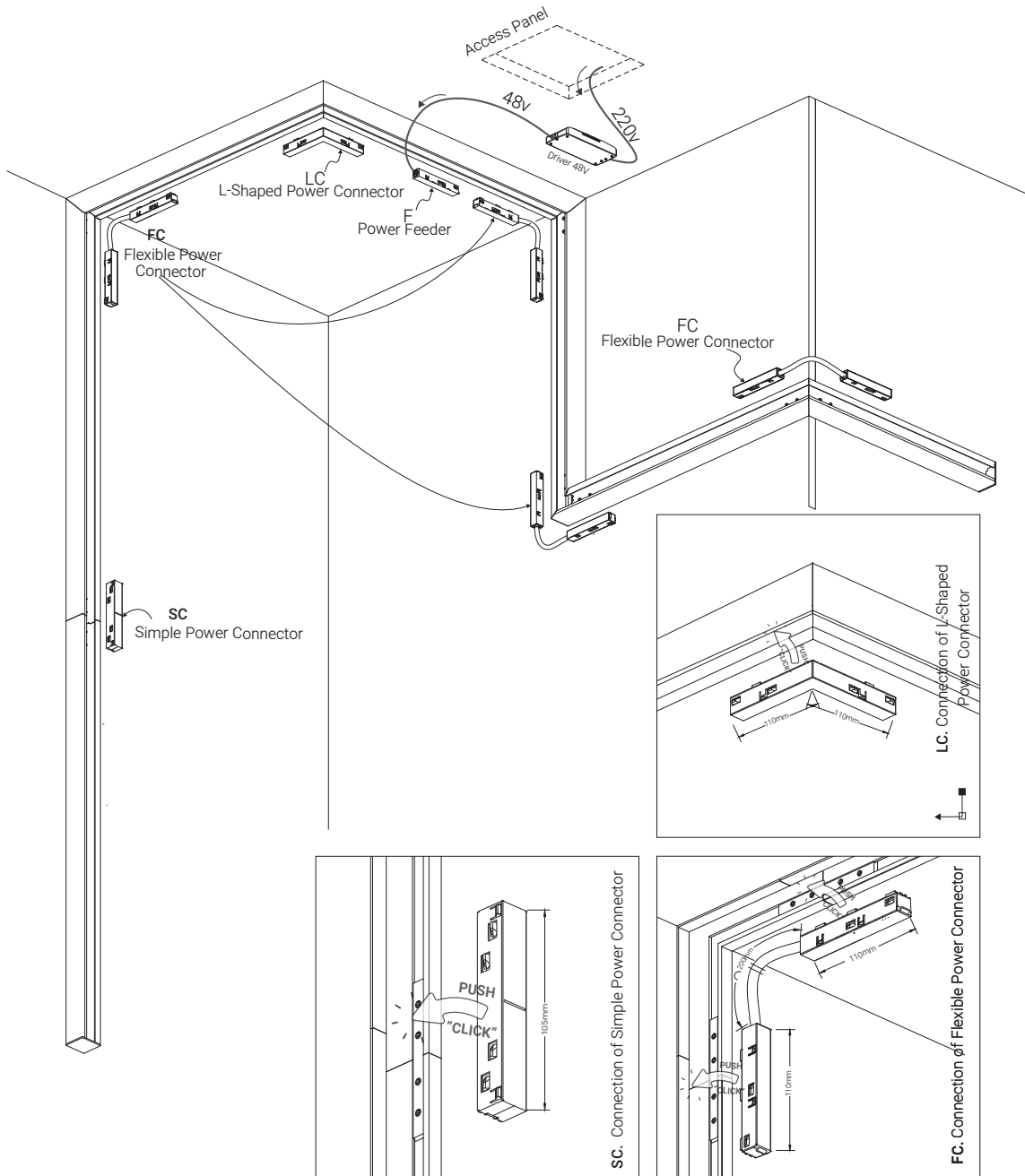

Installation of Surface-Mounted Profile (Low Height / Feeder Installation)

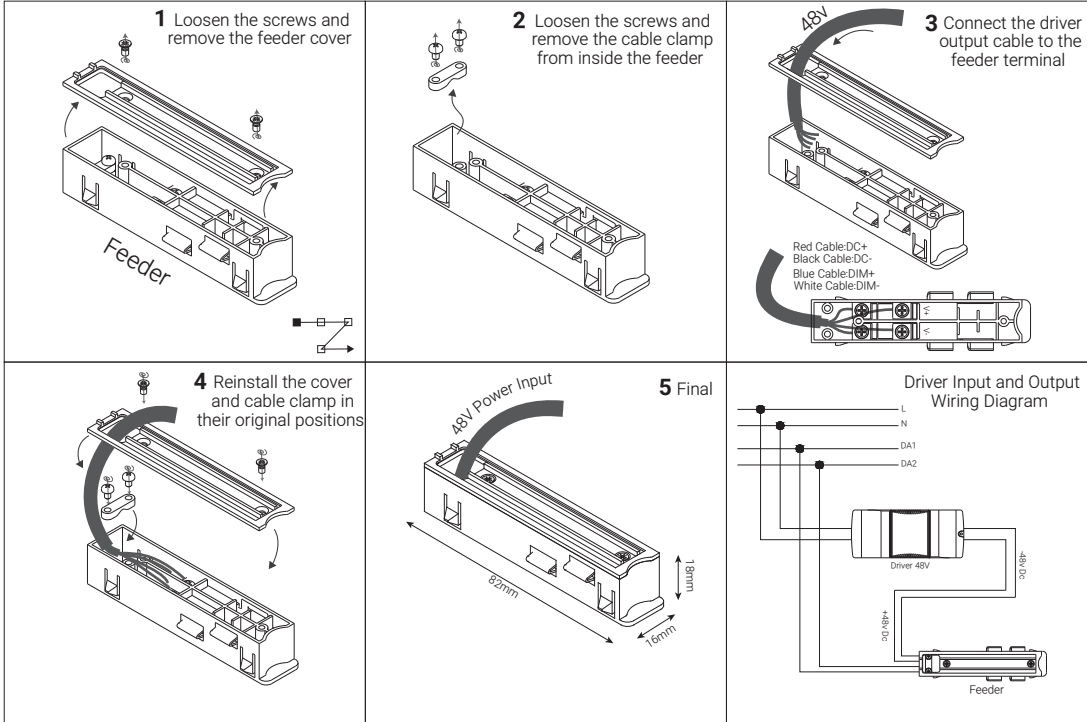

Method of Connecting the Power Supply Cable to the Rail via the Feeder

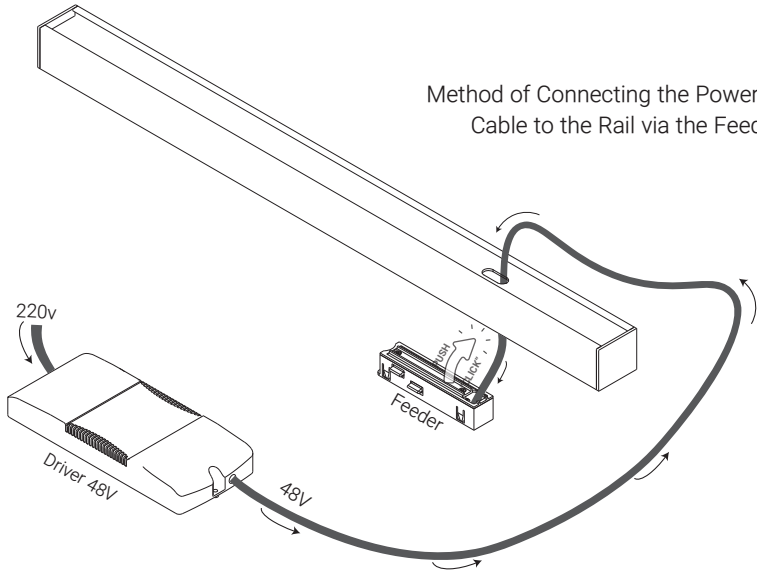

Installation of Pendant Profile (Low Height / Section View)

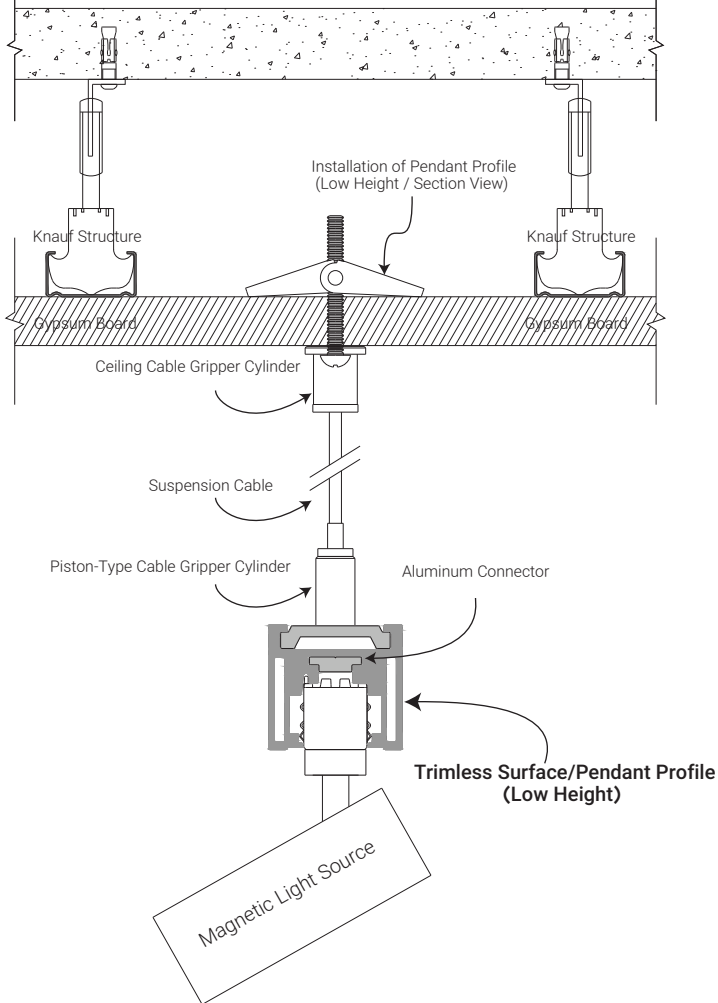

On-site cutting is permitted only with the manufacturer's approval.

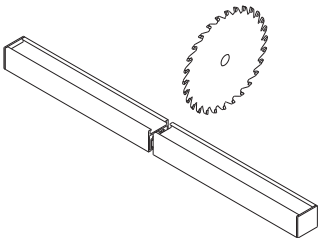

Do not remove the protective cover until final installation of the profile is completed.

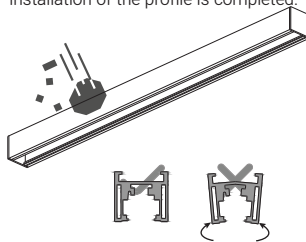

Do not connect 220V power directly to the Profile input (feeder).

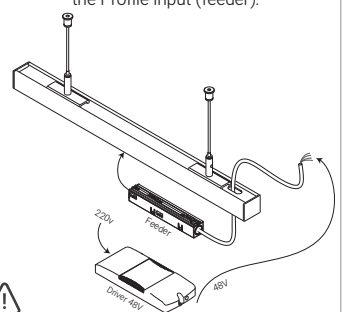

Installation of Pendant Profile (Low Height / Rail Installation)

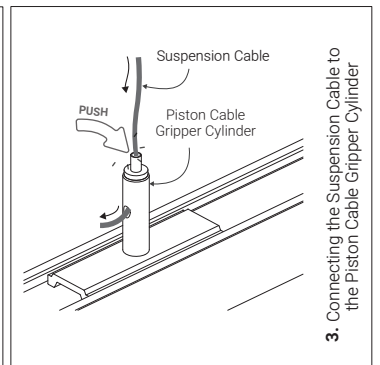
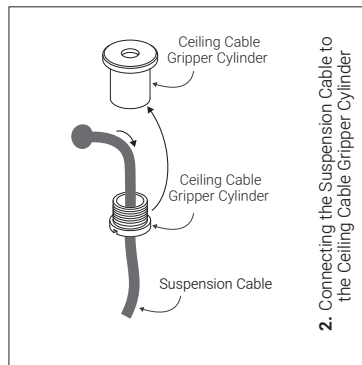
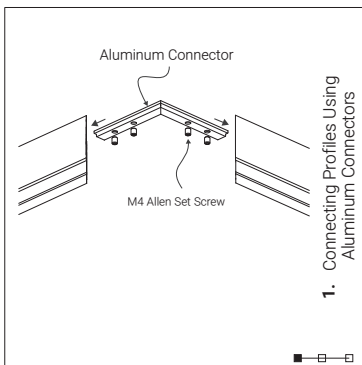
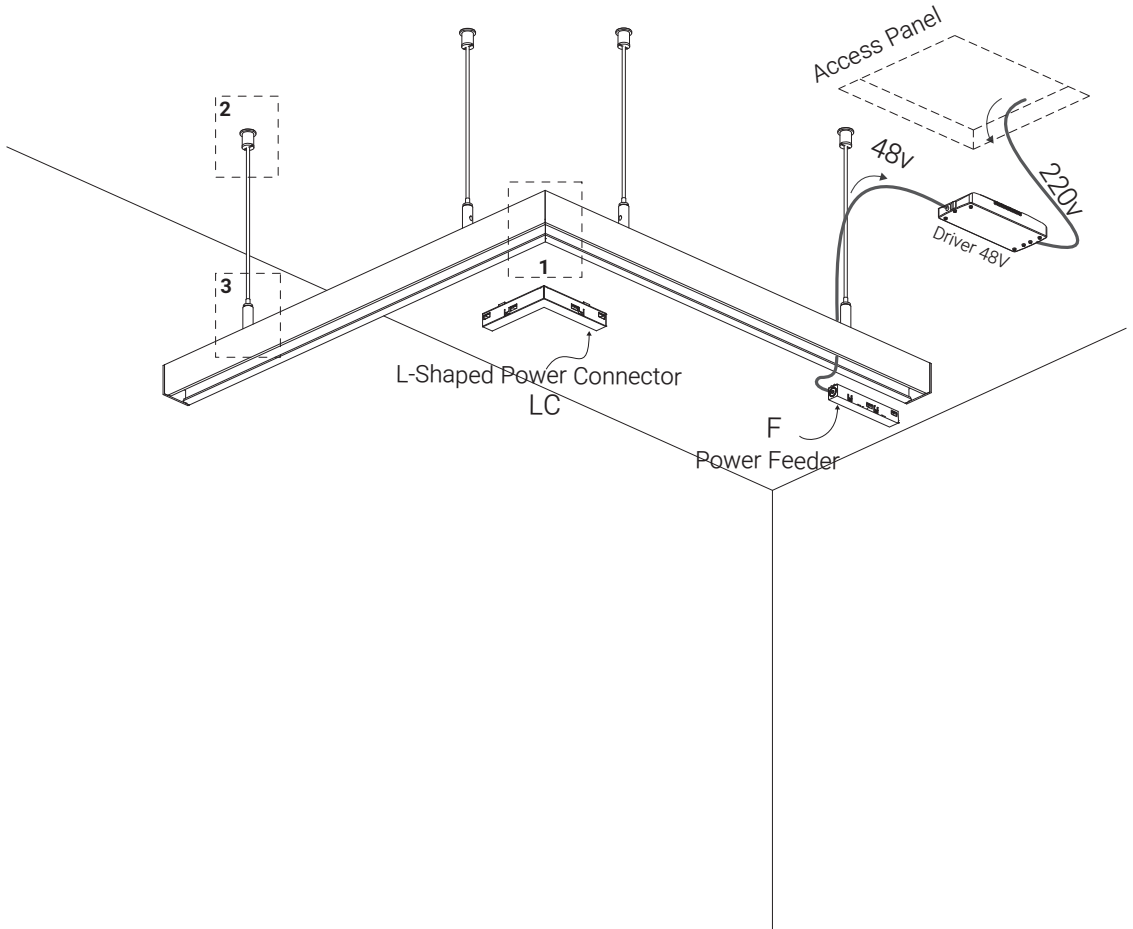

Installation of Pendant Profile (Low Height / Feeder Installation)

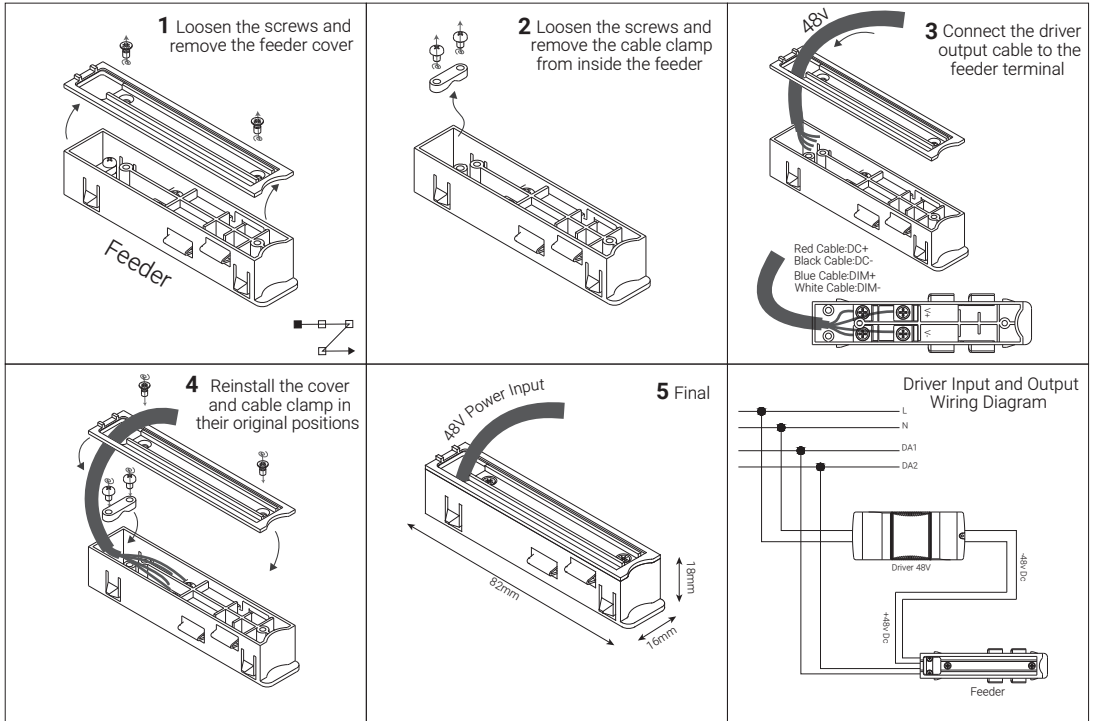

Method of Connecting the Power Supply Cable to the Rail via the Feeder

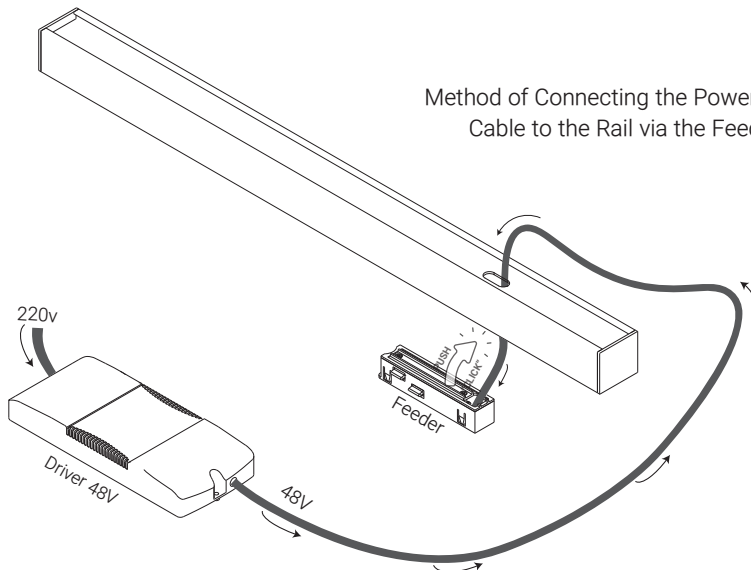

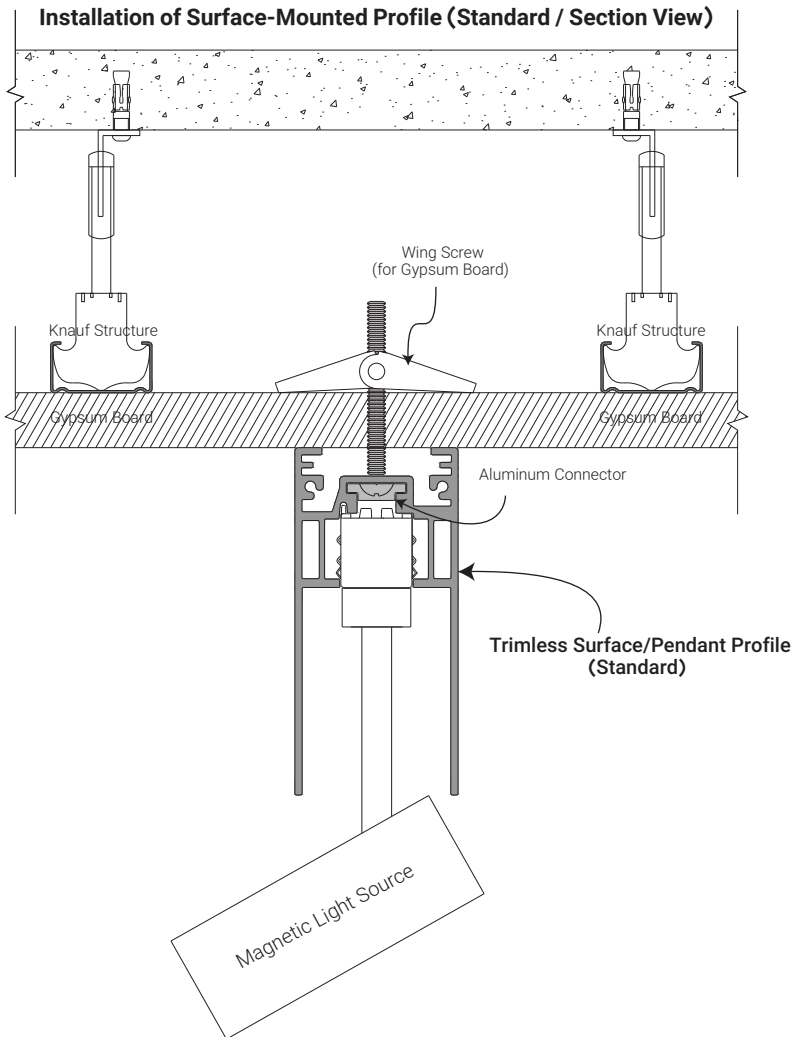

On-site cutting is permitted only with the manufacturer's approval.

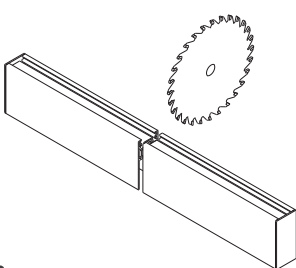

Do not remove the protective cover until final installation of the profile is completed.

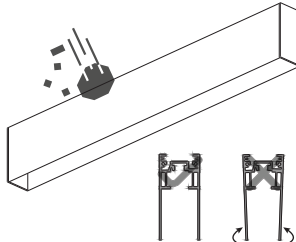

Do not connect 220V power directly to the Profile input (feeder).

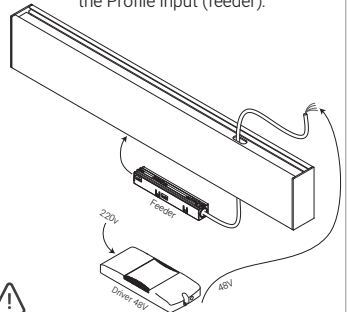

Installation of Surface-Mounted Profile (Standard / Profile Installation)

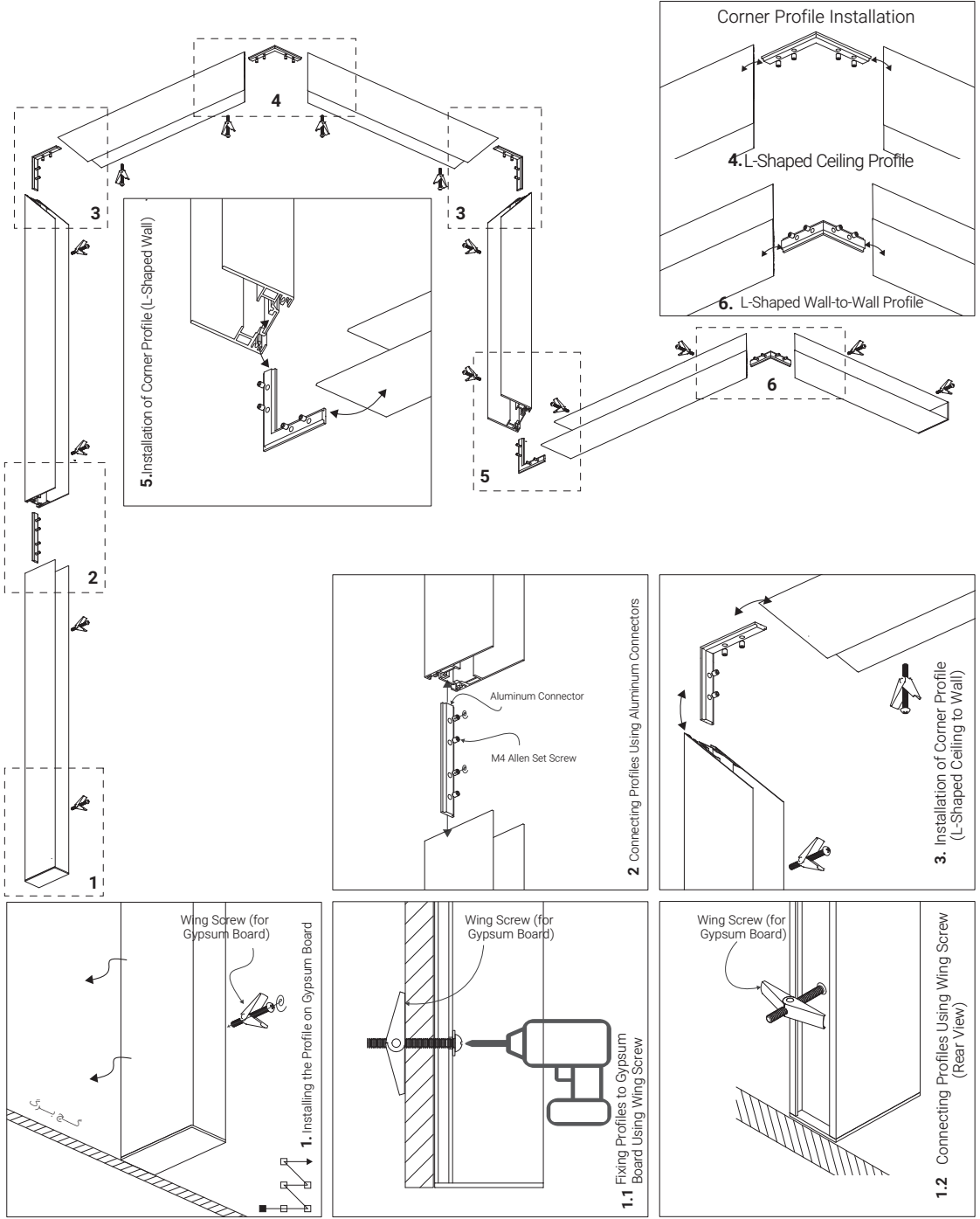

Installation of Surface-Mounted Profile (Standard / Electrical Connections Installation)

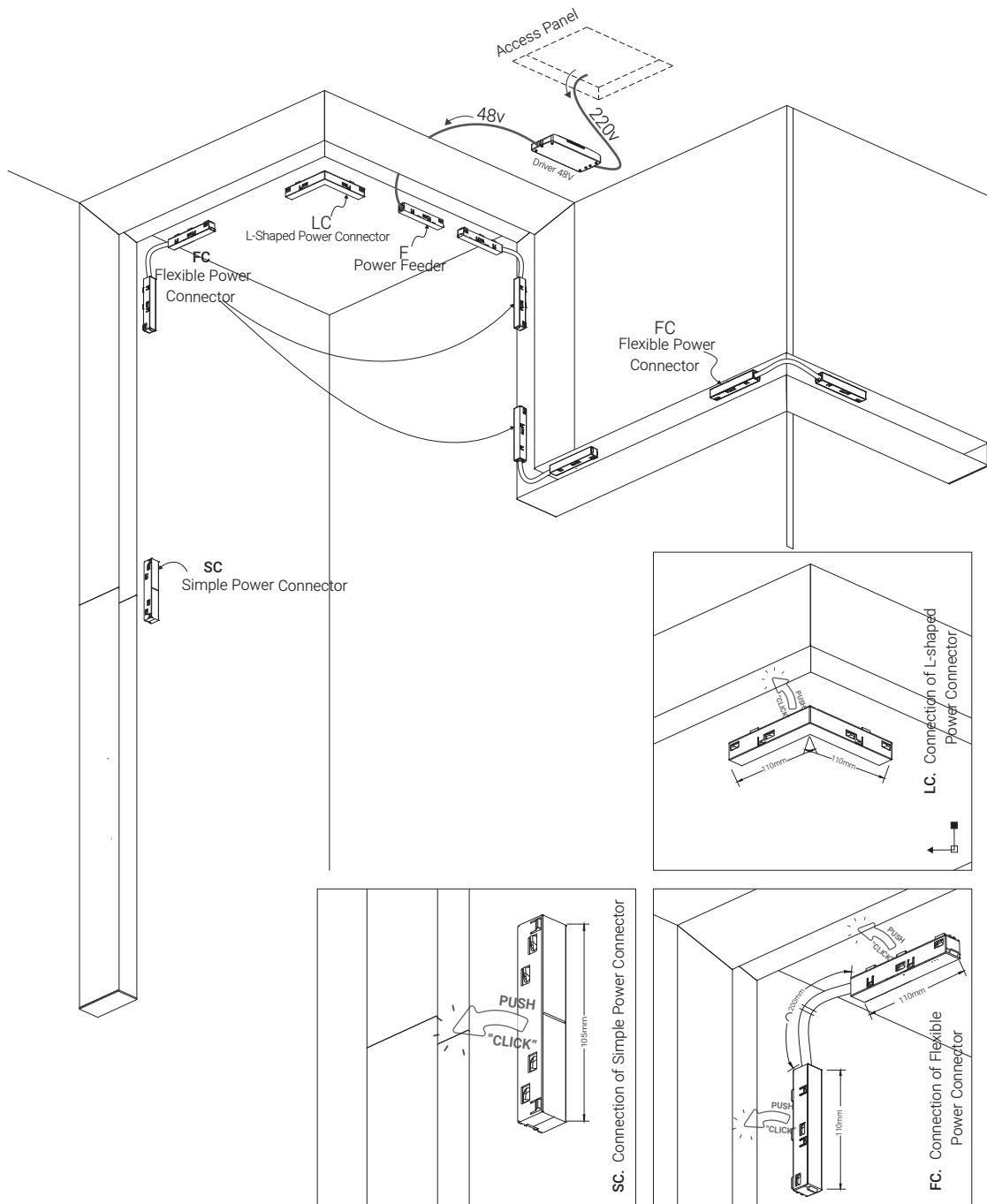

Installation of Surface-Mounted Profile (Low Height / Rail Installation)

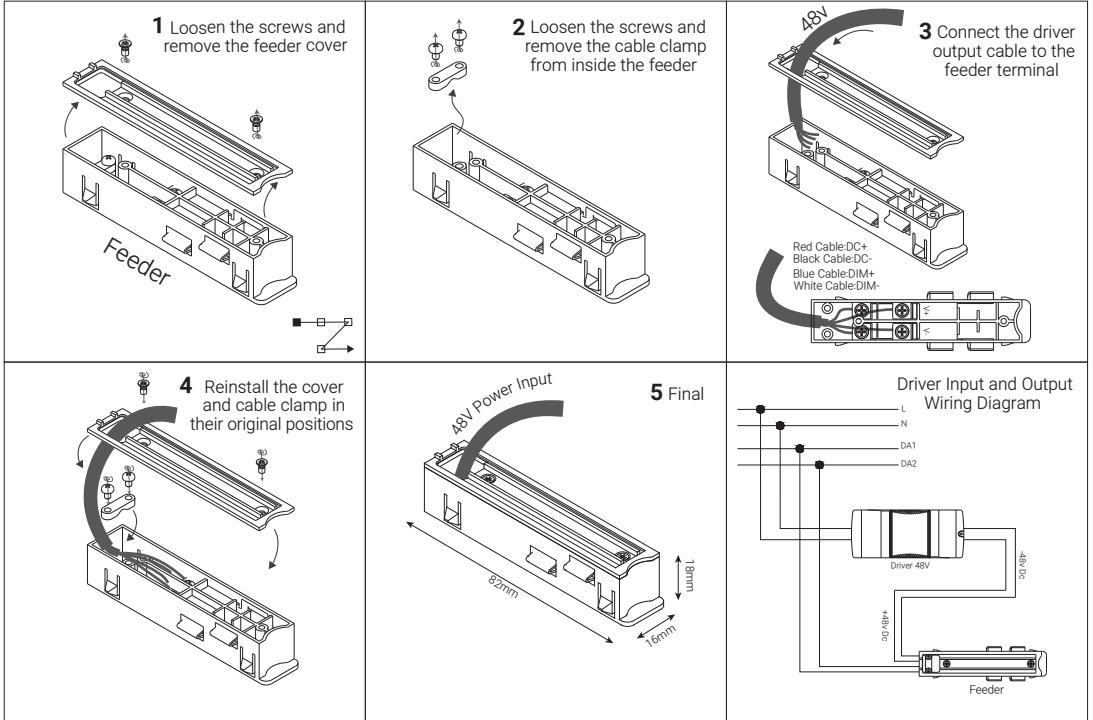

Method of Connecting the Power Supply Cable to the Rail via the Feeder

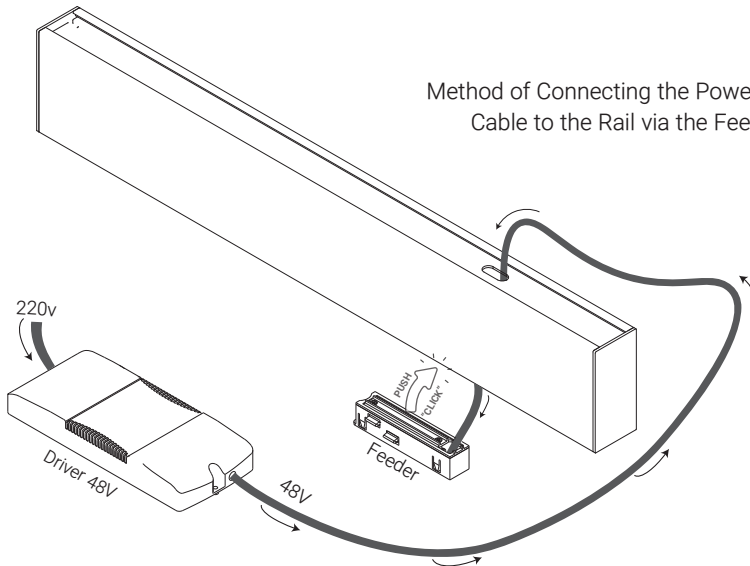

Installation of Pendant Profile (Standard / Profile Installation)

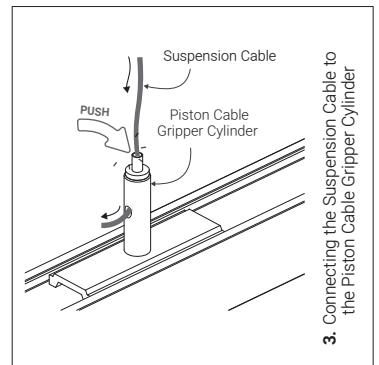
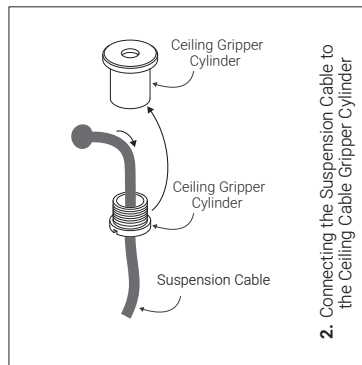
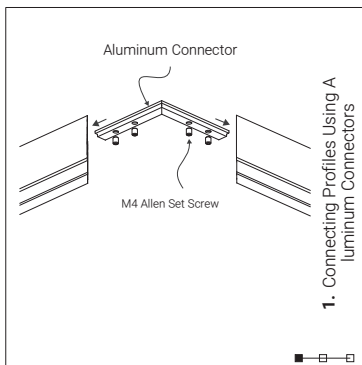
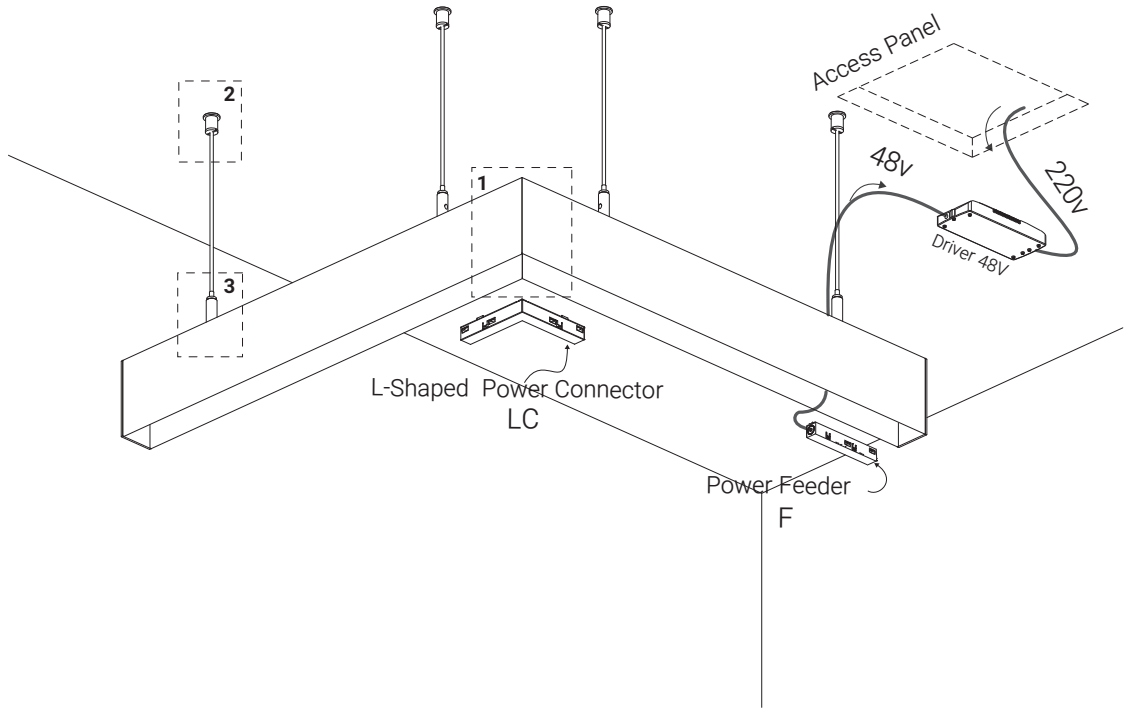

Installation of Pendant Profile (Standard / Feeder Installation)

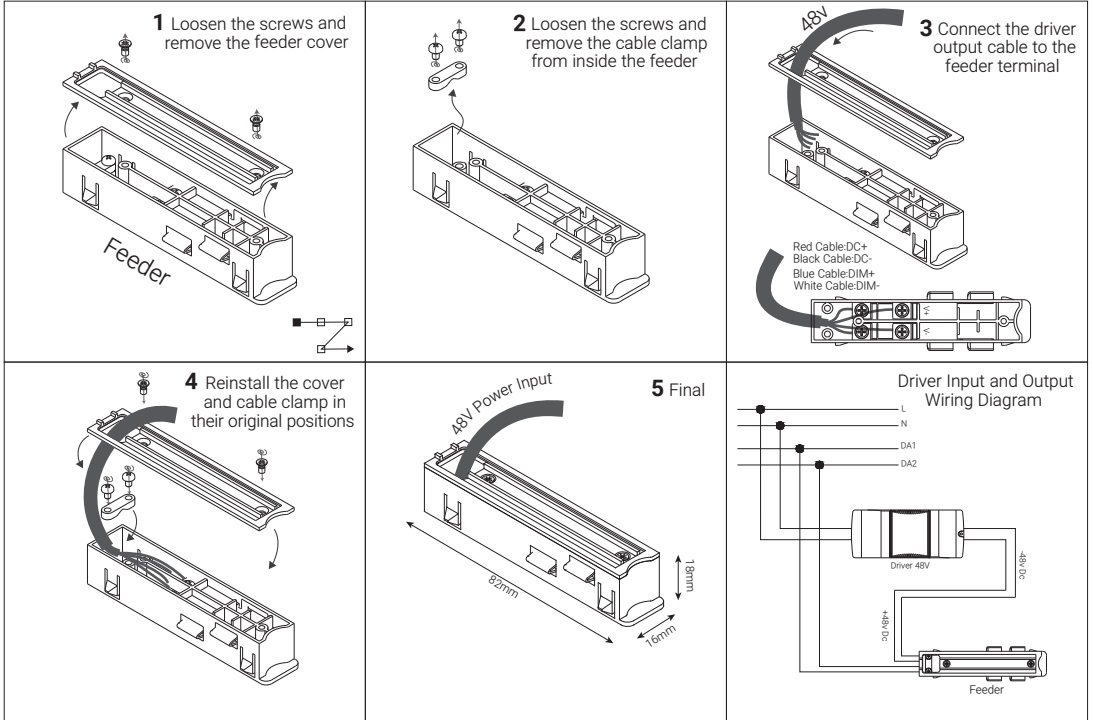

Method of Connecting the Power Supply Cable to the Rail via the Feeder

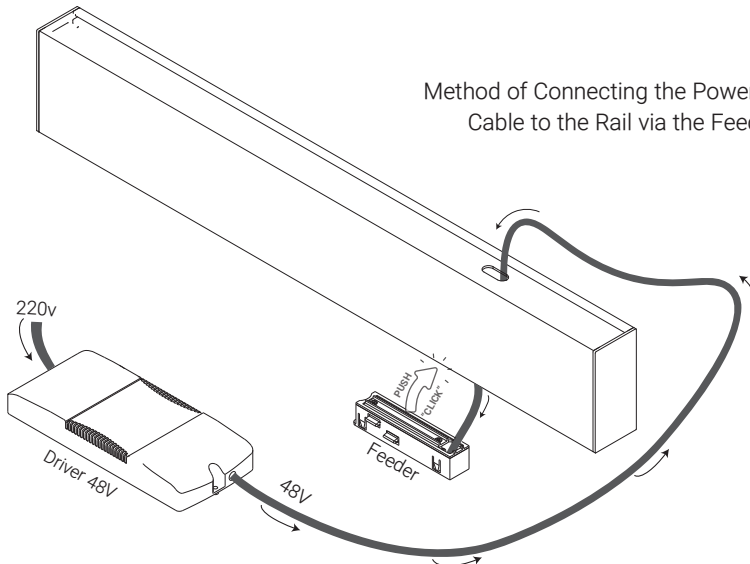

NEXO

L I G H T I N G

info@nexolighting.com

