

NEXO
LIGHTING

Installation guide

LINE

Line _____ v 1.0

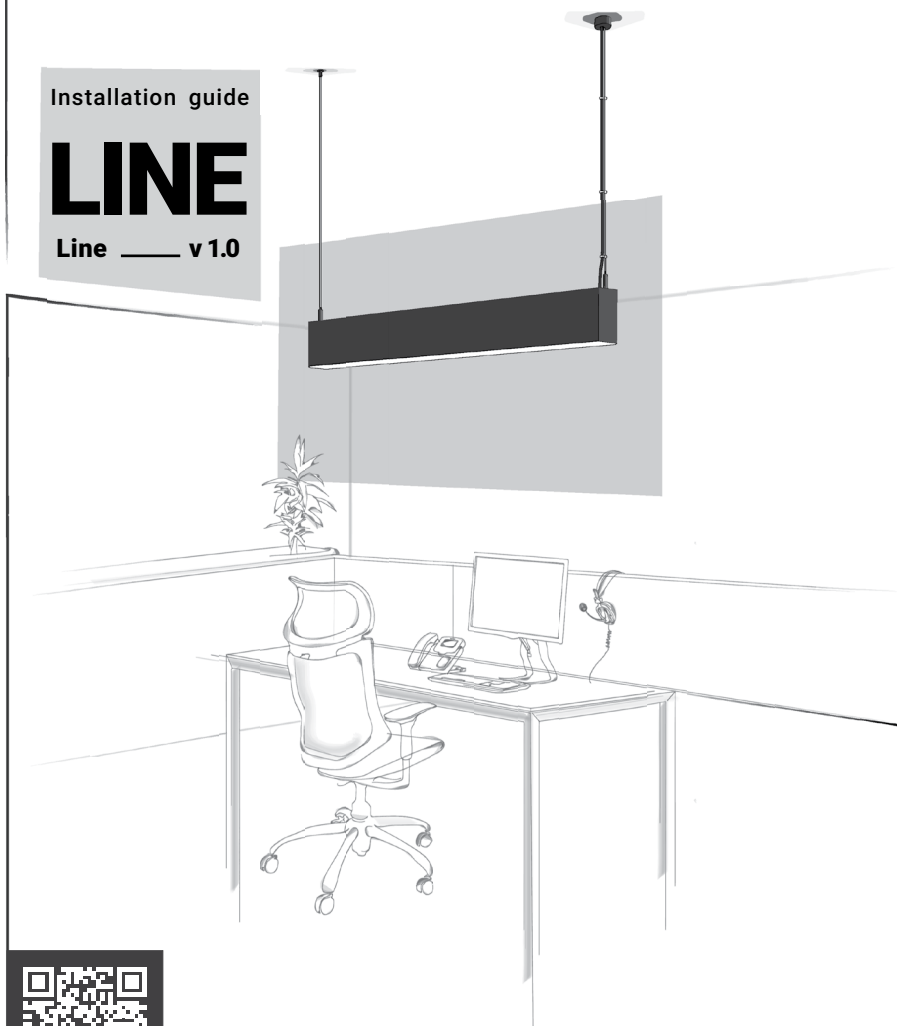

▶ PLAY VIDEO

nexolighting.com/installation-video/

Installation Manual for Linear Lights (Line Series) / Widths: 60 ,35, and 90 mm



DUBAI, UNITED ARAB EMIRATES.
TEL: (+971) 522 56 71 07
EMAIL: INFO@NEXOLIGHTING.COM

Index

Features and Components of Line Lights	1
Warnings.....	3
Weight of Line Lights	4
Packaging and Label	5
Arrangement of Line Lights	6
Installation of Pendant Line Lights	7
Installation of Surface-Mounted Line Lights	11
Installation of Recessed Trim Line Lights	14
Installation of Recessed Trimless Line Lights	18
Wiring Method	22
Notes	23
Installation Checklist	24

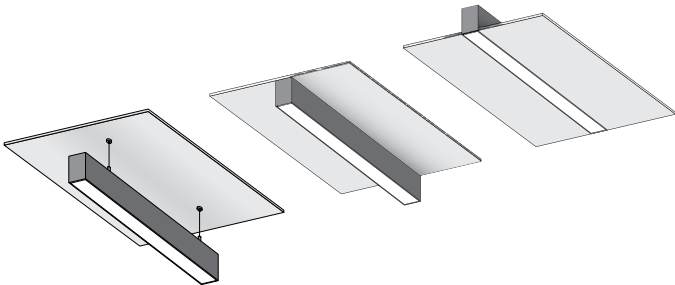







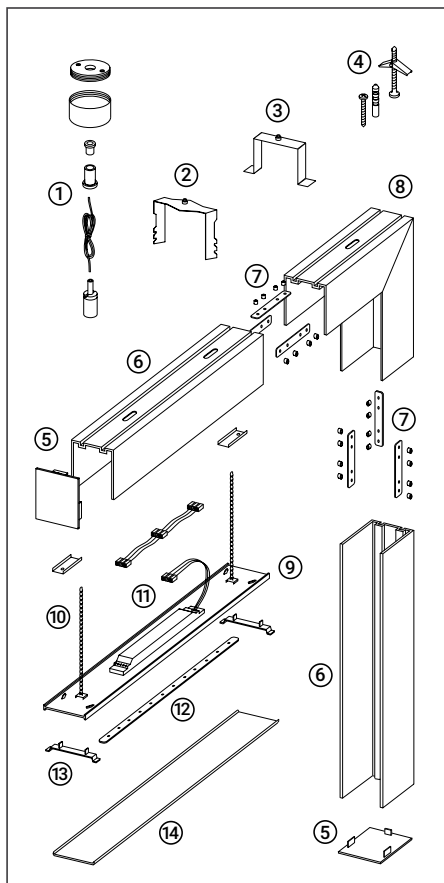

Dear Customer, thank you for your purchase and trust. Please read and review the instruction .manual before opening the product packaging

Features of Line Lights

- ❶ Available in widths of 60 ,35, and 90 mm
- ❶ High-efficiency SMD LED modules
- ❶ Milky acrylic diffuser (PS) for uniform light distribution
- ❶ Optional milky polycarbonate diffuser (PC)
- ❶ Resistant to scratches, impact, UV, and IR radiation
- ❶ Body made of extruded aluminum profile with electrostatic powder coating in custom colors
- ❶ LED modules with a lifespan of over 50,000 hours
- ❶ Through-wiring system
- ❶ Electronic driver with efficiency above %95 and
- ❶ power factor of 0.97

- ① Suspension kit for mounting the luminaire to the ceiling
- ② Rotational U-shaped bracket for recessed installation of trim models
- ③ Simple U-shaped bracket for recessed installation of trimless models
- ④ Surface-mount kit for installing the luminaire on ceilings or walls
- ⑤ End caps (start and end covers)
- ⑥ Luminaire profile (main body)
- ⑦ Connector for joining two profiles
- ⑧ Corner profile
- ⑨ Reflector
- ⑩ Safety cable
- ⑪ Driver
- ⑫ LED module
- ⑬ Reflector bracket
- ⑭ Diffuser

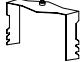
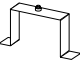

	Pendant Installation	Surface-mount Installation	Recessed Installation
 Connector bracket	 Light lenght exceeds 3m	 Light lenght exceeds 3m	 Light lenght exceeds 3m
 Suspension kit	1 Unit per 1.2 m		
 Surface-mount kit		1 Unit per 1 m	
 Rotational U-shaped bracket			1 Unit per 1.5 m
 Simple U-shaped bracket			1 Unit per 1.5 m

Warnings



Installation and use must be performed only by a qualified technician.



Power must be disconnected before installation. Follow international and safety standards.



All products come with a -5year warranty covering the quality of the components and the quality level of the light output.



The manufacturer is not responsible for damage caused by improper installation or usage.



Only the manufacturer, their representatives, or certified personnel may replace or modify the light source.



Caution! Risk of electric shock.



Avoid compressing or striking the product during transport and storage



Do not touch the LED module directly or strike it.



Avoid impact or pressure on the diffuser and luminaire body.



No drilling, cutting, or modification of the luminaire's electrical system is required.



Install the luminaire at the final stage of finishing works.



For any questions or further information, please contact NEXO after-sales service.

Approximate weight of linear lights



NL35 – 30 mm width:
1.3 kg per meter



NL50 – 50 mm width:
1.4 kg per meter



NL60 – 60 mm width:
1.75 kg per meter



NL60 LH (Low Height) – 60 mm width:
1.45 kg per meter



NL90 – 90 mm width:
2.2 kg per meter



NL90 LH (Low Height) – 90 mm width:
1.75 kg per meter

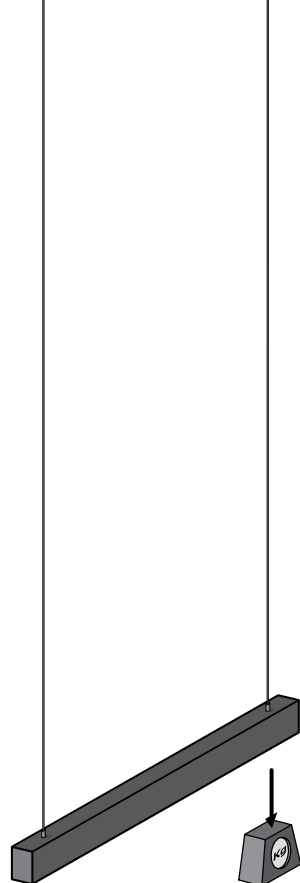

All Line series installed in outdoor areas, parking spaces, or humid environments require consultation with our technical experts.

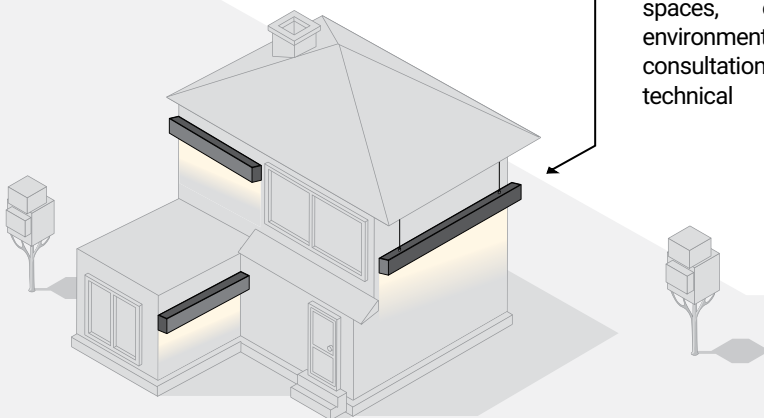

Arrangement of Line Luminaires

Single Line:

Luminaire length less than 284 cm.

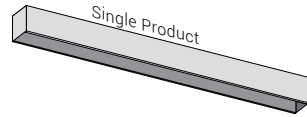

Continuous Line:

Luminaire length greater than 284 cm.

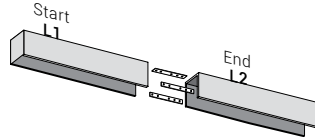

L-Shaped Line:

Arrangement of L-shaped Line for installation on ceilings with dimensions greater than 204 cm.

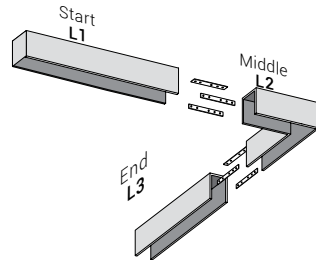

L-Shaped Line (Ceiling to Wall):

Arrangement of L-shaped Line for installation on ceilings extending onto walls, for dimensions greater than 284 cm.

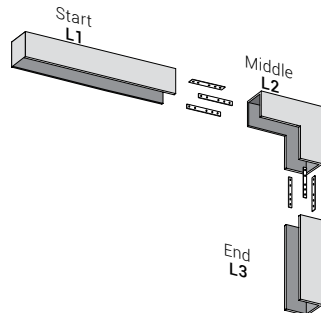

U-Shaped and Rectangular Line:

Arrangement of U-shaped and rectangular Line for installation on ceilings or walls with dimensions greater than 180 cm.

For correct arrangement according to your order, please refer to the installation diagram included in the packaging.

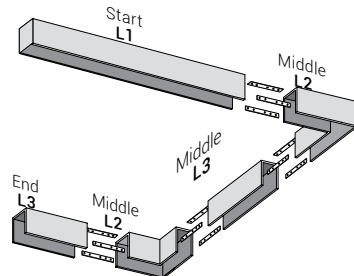

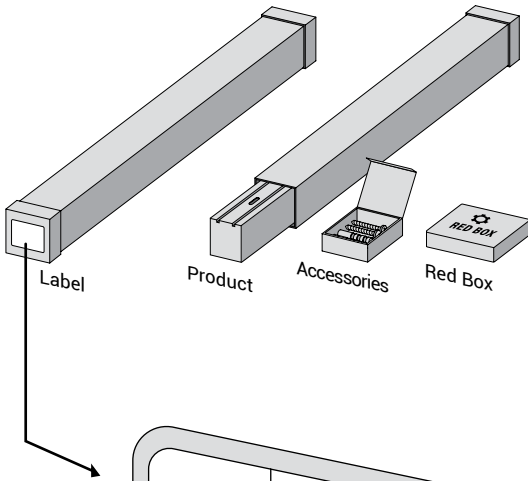

Packaging:

The carton has lids at both the front and rear ends.

Carton length varies according to the ordered dimensions.

The package contains the product, installation accessories, the instruction manual, and the installation diagram.

Product Name & Code		Customer Name	Installation Type
Product Description			Lifespan
Voltage	Quality Grade		Ingress protection
Light Meter Code			Weight per Meter
Line Length & Number			

Specification Label

All necessary information for complete product identification is provided on the label. The label is affixed to the beginning or the end of the packaging (on the top flap of the carton).

Line Light Installation Guide

Pendant

PMp

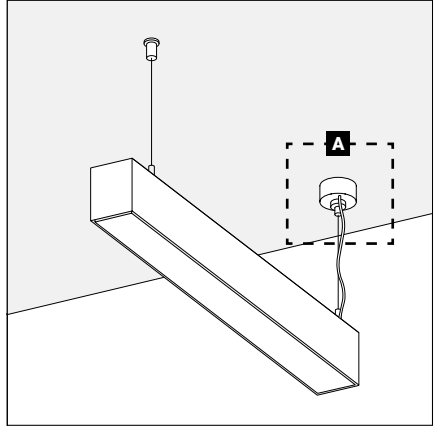

A. Section One:

Installing the Suspension Cable Gripper to the Ceiling

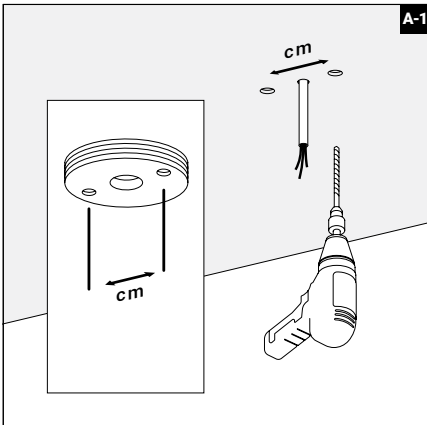

A-1. Drilling the Ceiling

Drill the ceiling according to the hole spacing on the suspension cable gripper cover.

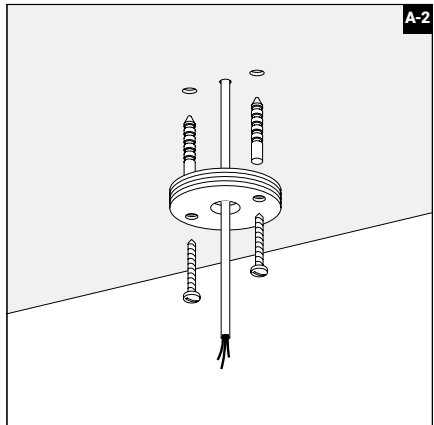

A-2. Installing the Upper Cover of the Suspension Cable Gripper

Pass the building power cable through the upper cover of the suspension cable gripper and fix the cover to the ceiling using screws and wall plugs, or toggle bolts (for gypsum board ceilings).

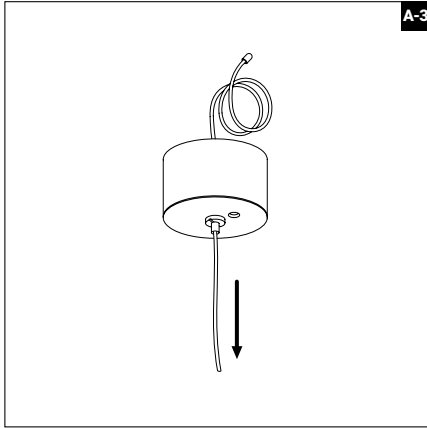

A-3. Installing the Suspension Cable Gripper
Pass the suspension cable through the cable gripper.

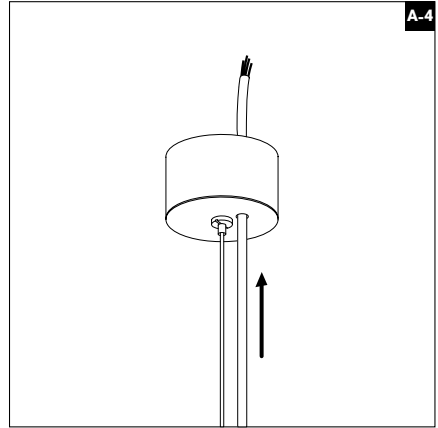

A-4. Passing the Luminaire Cable
Pass the luminaire power cable through the cable gripper.

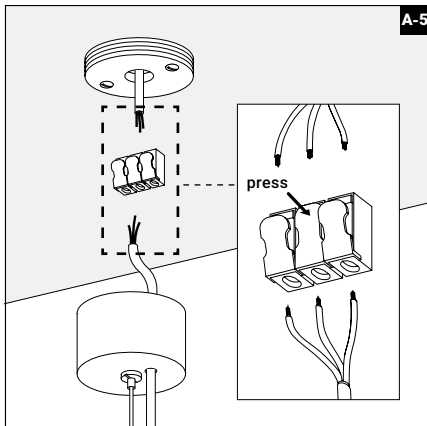

A-5. Electrical Connections
Connect the luminaire power cable to the building power cable using a terminal block. For detailed instructions on wiring the dimmable system, refer to the relevant pages.

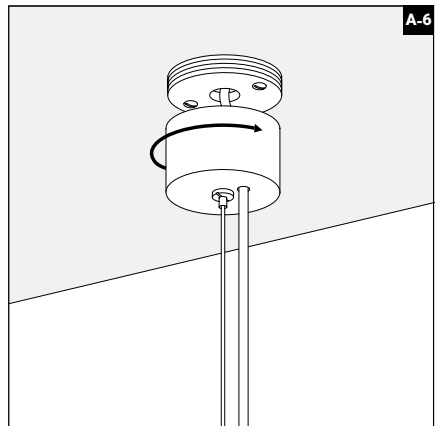

A-6. Fixing the Suspension Cable Gripper to the Ceiling
Join the two parts of the suspension cable gripper together on the ceiling.

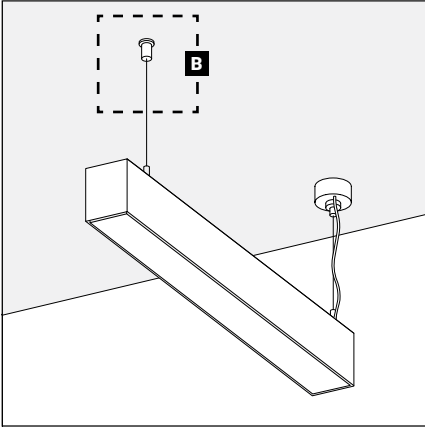

B. Section Two:

Installing the Suspension Cable to the Ceiling

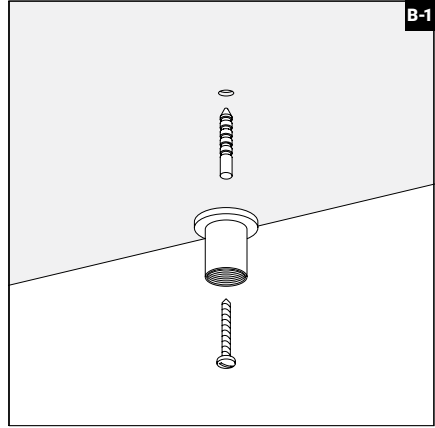

B-1. Fixing the Ceiling Canopy Nut

Connect the ceiling canopy nut using screws or toggle bolts (for gypsum board ceilings).

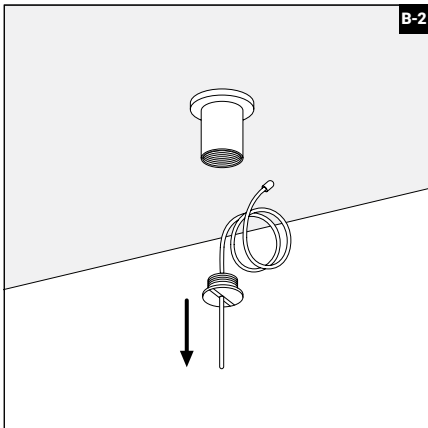

B-2. Attaching the Suspension Cable

Pass the suspension cable through the canopy screw.

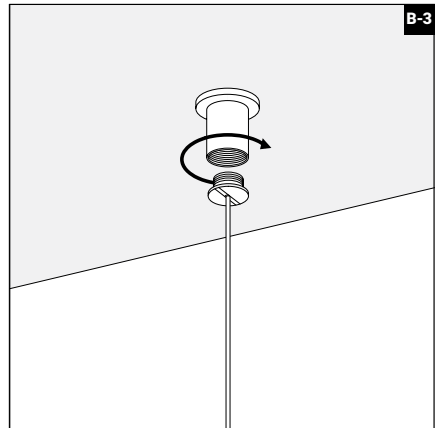

B-3. Installing the Canopy Screw

Join the two parts of the ceiling canopy together on the ceiling.

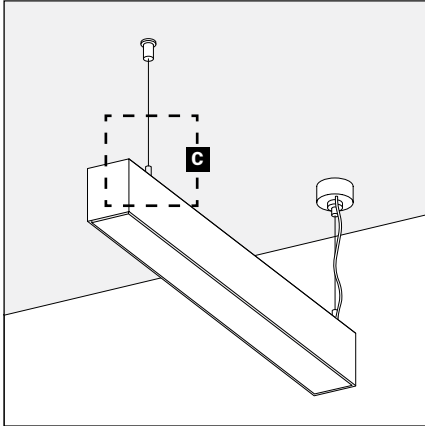

C. Section Three:
Attaching the Suspension Cable to the Luminaire Body

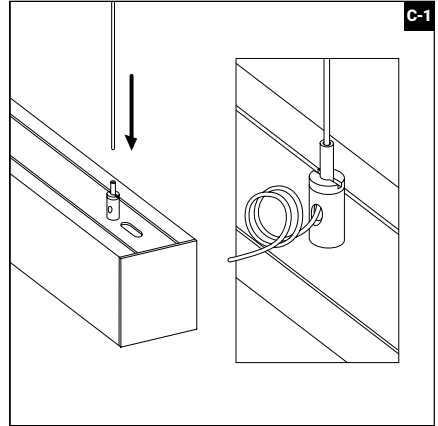

C-1. Fixing the Suspension Cable to the Rear Capsule of the Luminaire

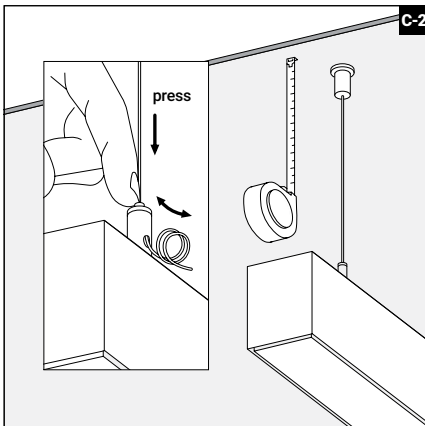

C-2. Adjusting the Ceiling Canopy Nut
Adjust the suspension cable length (shortening or extending) by pressing the release pin

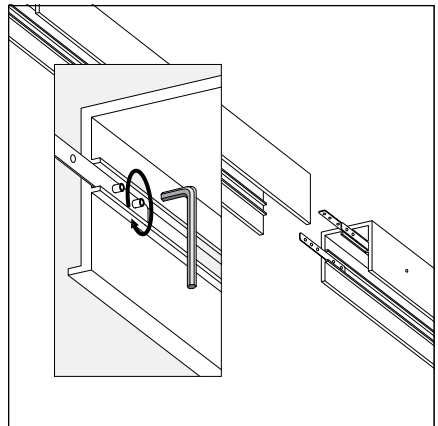

Preparing and Installing the Connection Bracket (Connector)

At this stage, using the connection bracket, two sections of the linear luminaire are prepared to be joined together in a continuous line. Tightening at least three screws of the connection bracket is mandatory

Line Light Installation Guide

Surface Mounted

PM

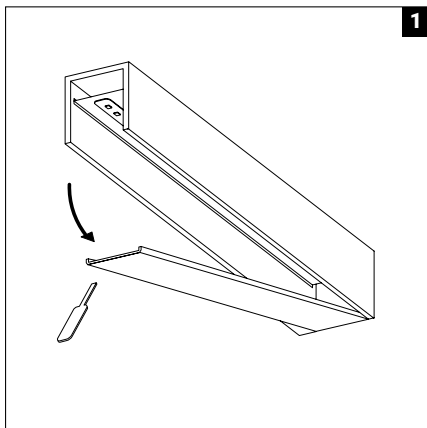

1. Removing the Diffuser

Using the dedicated tool provided in the box, remove the diffuser from the luminaire body. Please remove it starting from the correct end of the line.

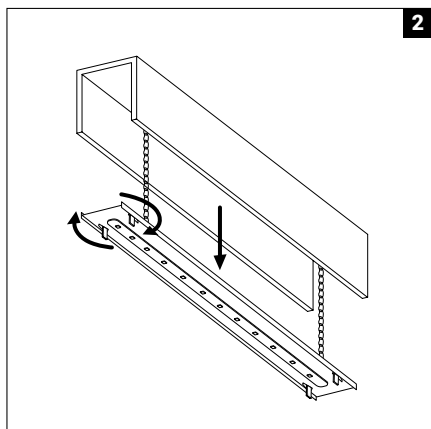

2. Removing the Reflector

To remove the reflector, rotate the retaining clip in the correct direction or press it inward.

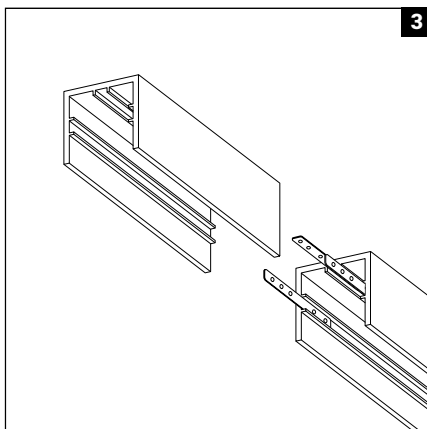

3. Preparing the Connection Bracket (Connector)

At this stage, use the connection bracket to prepare two sections of the linear luminaire to be joined in a continuous line.

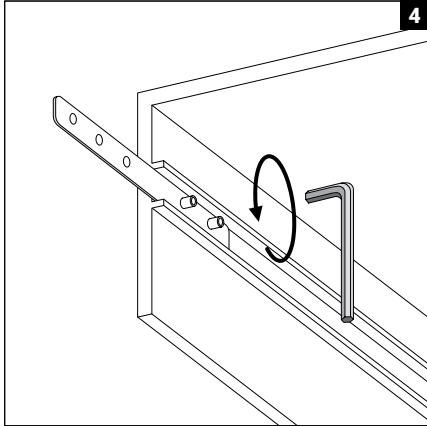

4. Installing the Connection Bracket

The required Allen key is included in the accessories pack. Tightening at least three screws of the connection bracket is mandatory.

⚠ Warning: Do not overtighten the screws.

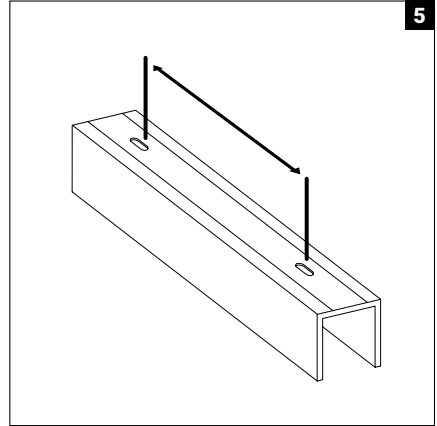

5. Marking the Positions

Mark the distance between the two slotted (oval-shaped) holes.

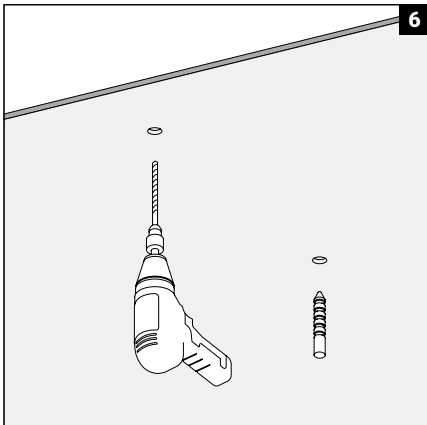

6. Drilling the Ceiling

Drill the ceiling using a 4 mm drill bit.

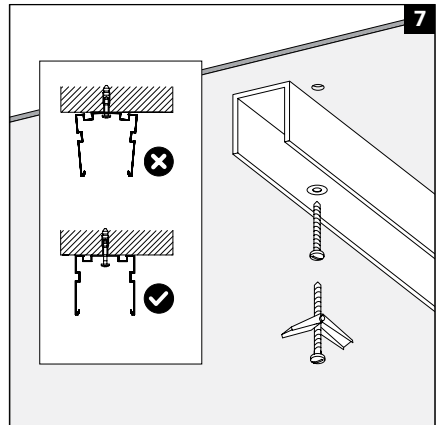

7. Fixing the Luminaire Body to the Ceiling

Fix the luminaire body to the ceiling using screws and wall plugs, or toggle bolts.

⚠ Warning: Do not overtighten the screws.

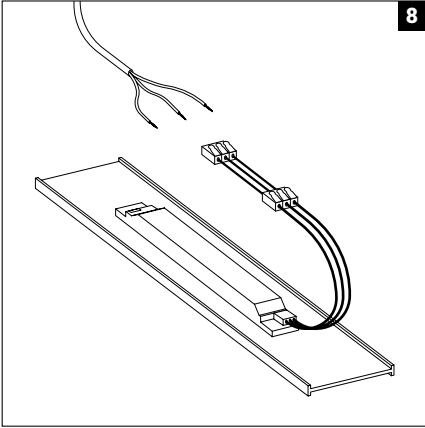

8. Connecting the Power Cable

Connect the luminaire power cable to the building power cable using a terminal block.

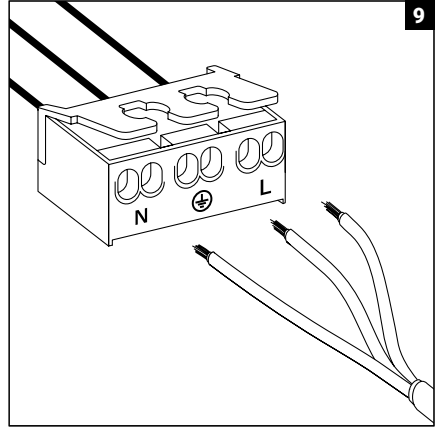

9. Connect the luminaire power

For detailed instructions on wiring the dimmable system, refer to the relevant pages

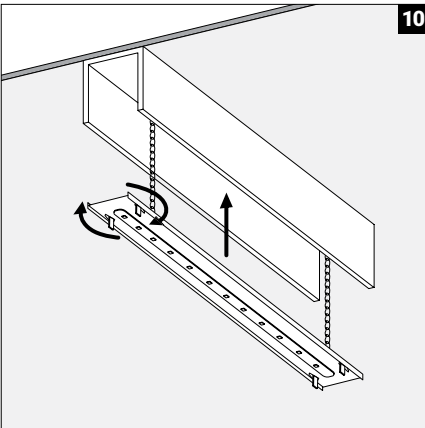

14. Reinstalling the Reflector

To install the reflector, rotate the retaining clip in the correct direction.

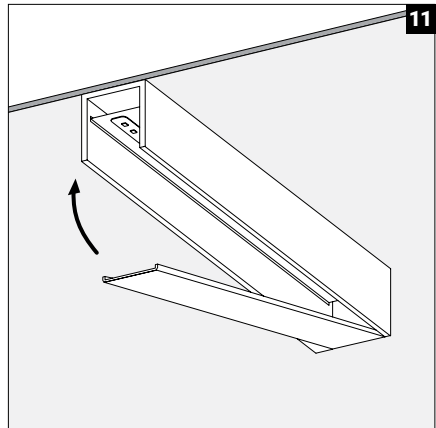

15. Installing the Diffuser

Please use a microfiber cloth to clean the diffuser.

(Microfiber cloth: nano-fiber cloth that does not leave lint and provides uniform polishing.)

Line Light Installation Guide

Recessed

PMi / Trim

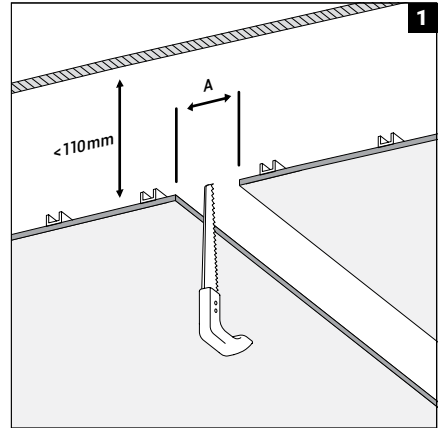

1. Substructure Preparing

A: Cut the gypsum board slot according to the luminaire size (as shown in the next step illustration).

The minimum distance between the gypsum board and the main ceiling must be 110 mm.

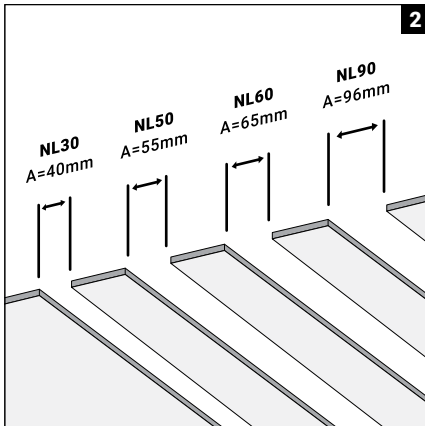

2. Gypsum Board Cut-Out Width for Different Profiles

NL90 Line: 95 mm

NL60 Line: 65 mm

NL50 Line: 55 mm

NL30 Line: 40 mm

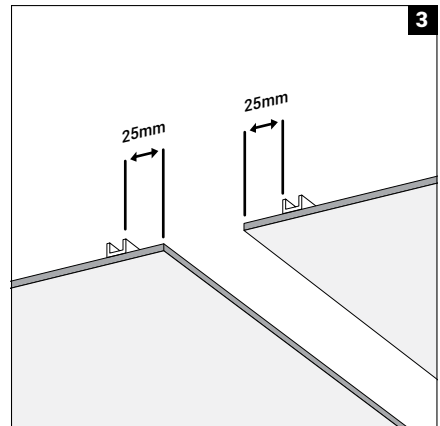

3. Substructure Preparing

The distance between the U-channel and the edge of the gypsum board must be 25 mm.

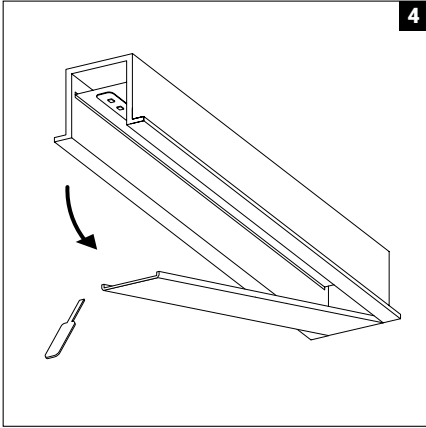

4. Removing the Diffuser

Using the dedicated tool provided in the box, remove the diffuser from the luminaire body. Please remove it from the correct end of the line.

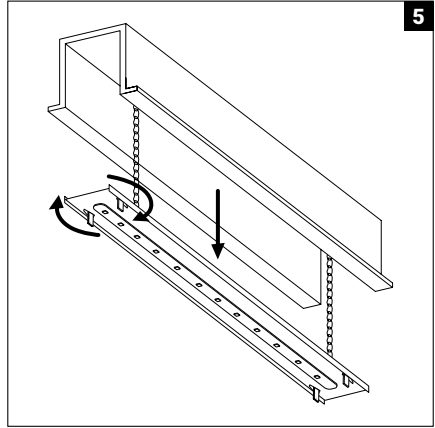

5. Removing the Reflector

To remove the reflector, rotate the retaining clip in the correct direction.

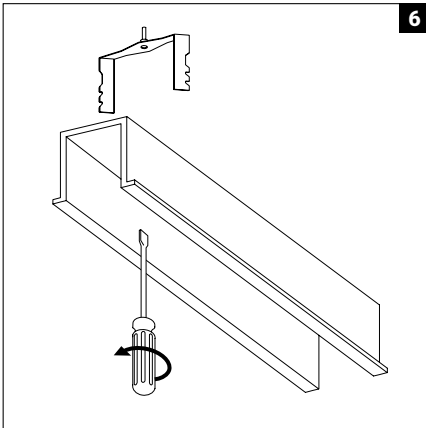

6. Installing the Rotational U-Shaped Bracket

At this stage, use the U-shaped bracket to prepare the luminaire for installation on the false ceiling.

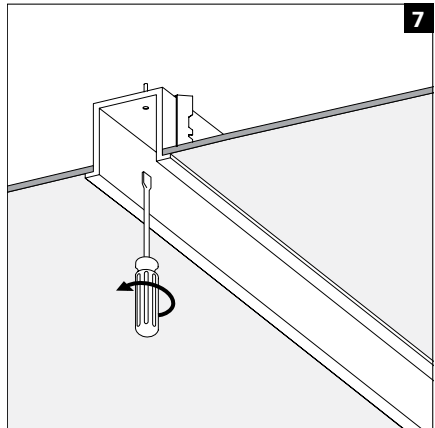

7. Fixing the Luminaire with the U-Shaped Bracket

By rotating the U-shaped bracket in the correct direction, the luminaire is fixed to the false ceiling.

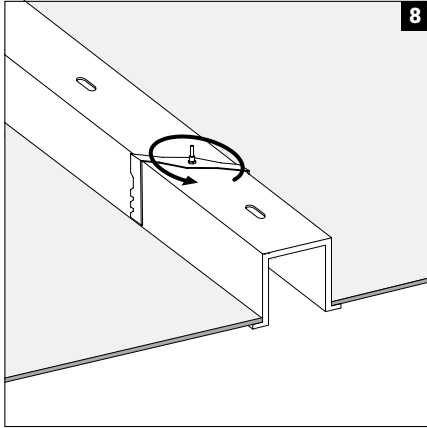

8. Detailed View of U-Shaped Bracket Rotation

Illustration of the rotation of the U-shaped bracket

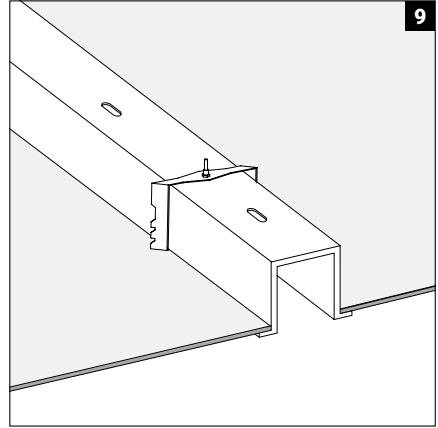

9. Detailed View of U-Shaped Bracket Rotation

Preparing the substructure of trim recessed Line

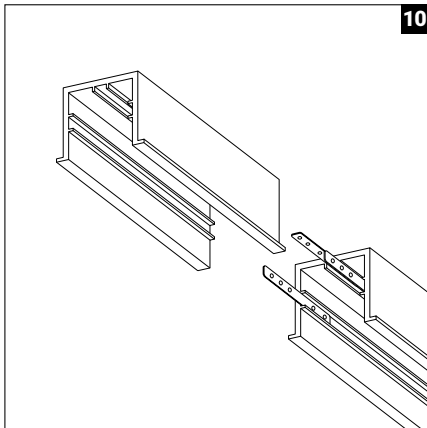

10. Preparing the Connection Bracket

Use the connection bracket to prepare two sections of the linear luminaire to be joined in a continuous line.

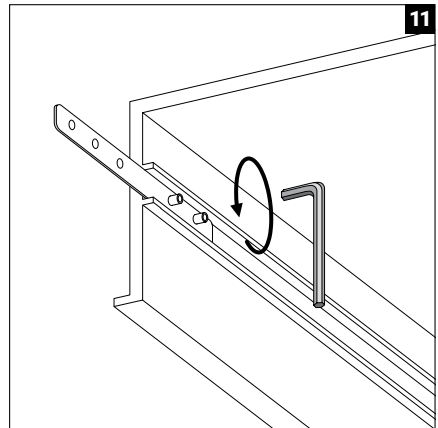

11. Installing the Connection Bracket

The required Allen key is included in the accessories pack.

Tightening at least three screws of the connection bracket is mandatory.

Do not overtighten the screws.

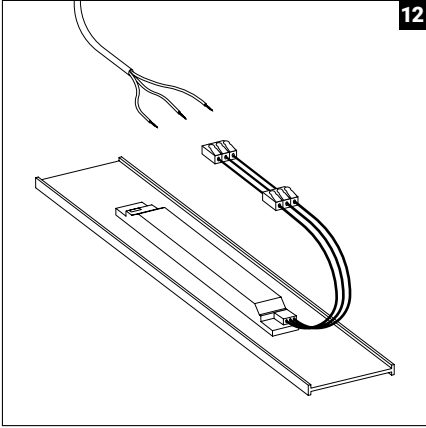

12. Connecting the Power Cable

Connect the luminaire power cable to the building power cable using a terminal block.

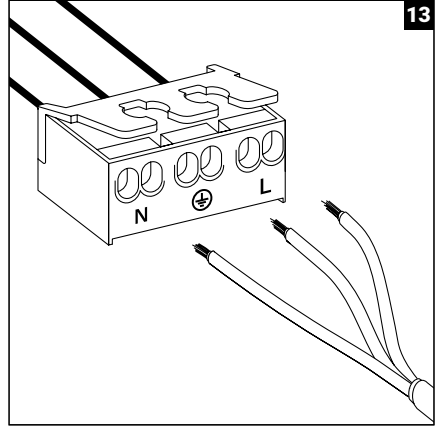

13. Dimmable System Wiring

For detailed instructions on wiring the dimmable system, refer to the relevant pages.

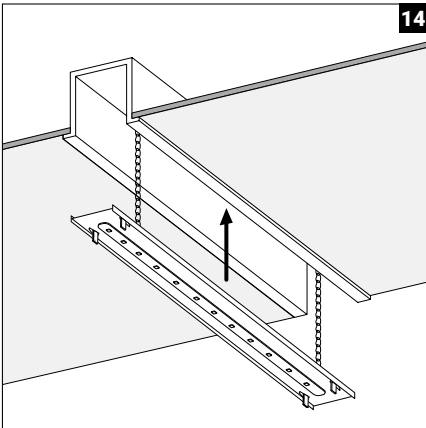

14. Reinstalling the Reflector

To install the reflector, rotate the retaining clip in the correct direction.

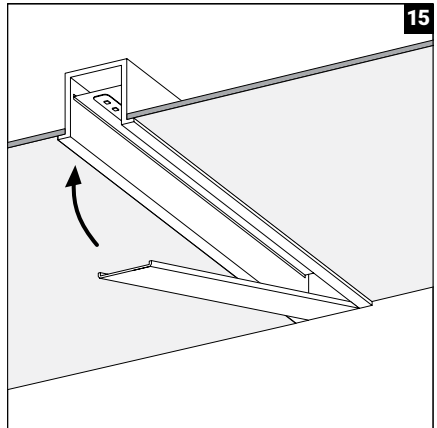

15. Installing the Diffuser

Please use a microfiber cloth to clean the diffuser.

(Microfiber cloth: nano-fiber cloth that does not leave lint and provides uniform polishing.)

Line Light Installation Guide

Recessed

PMiT/Trimless

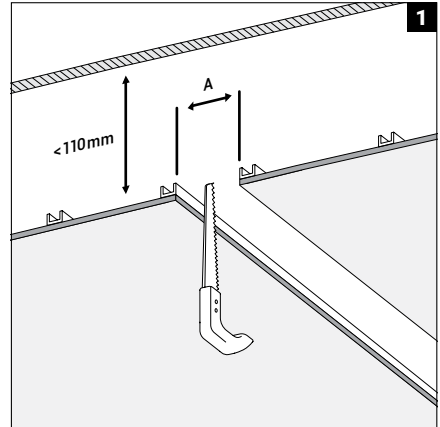

1. Preparing the substructure of trimless recessed Line

A: Cut the gypsum board slot according to the luminaire size (as shown in the next step illustration).

The minimum distance between the gypsum board and the main ceiling must be 110 mm.

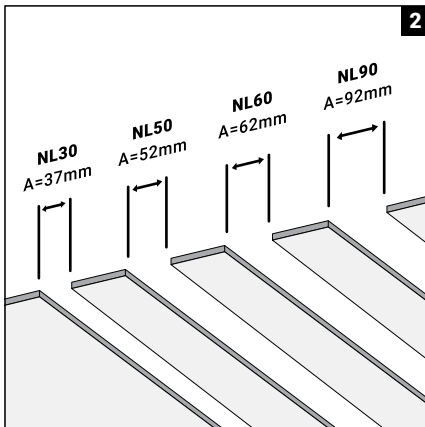

2. Gypsum Board Cut-Out Width for Different Profiles

NL90 Line: 95 mm

NL60 Line: 65 mm

NL50 Line: 55 mm

NL30 Line: 40 mm

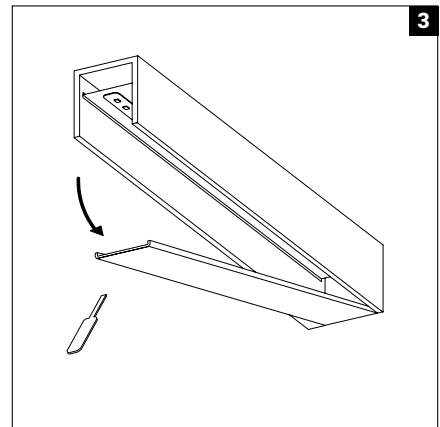

3. Removing the Diffuser

Using the dedicated tool provided in the box, remove the diffuser from the luminaire body.

Please remove it from the correct end of the line.

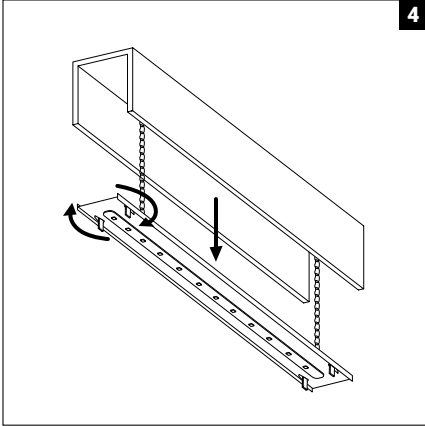

4. Removing the Reflector

To remove the reflector, rotate the retaining clip in the correct direction or press it inward.

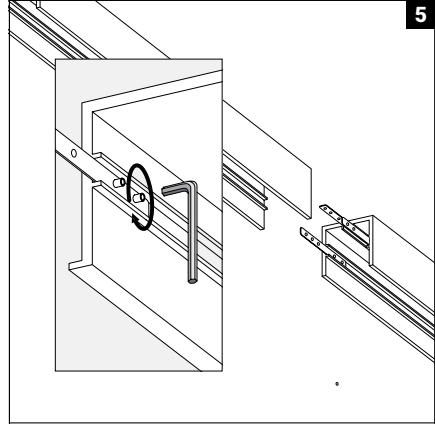

5. Preparing and Installing the Connection Bracket (Connector)

Use the connection bracket to prepare two sections of the linear luminaire to be joined in a continuous line.

Tightening at least three screws of the connection bracket is mandatory.

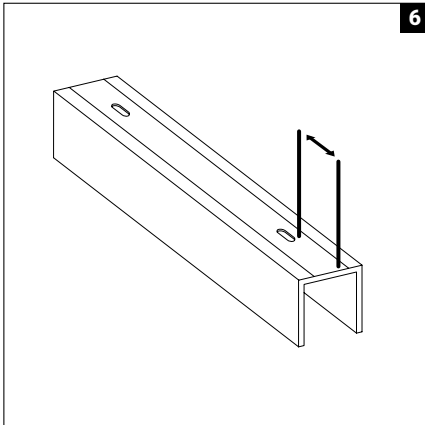

6. Measuring

Measure the position of the U-shaped brackets according to the punched holes on the back of the profile.

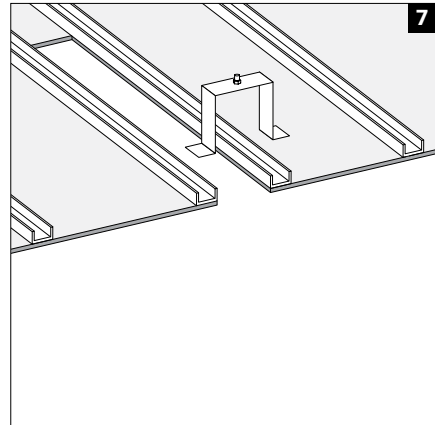

7. Installing the U-Shaped Bracket

Place the U-shaped bracket behind the gypsum board as shown in the illustration.

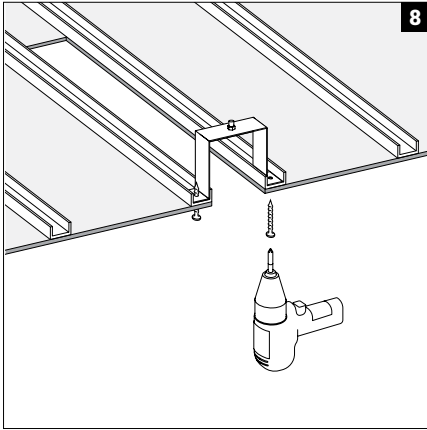

8. Fixing the U-Shaped Bracket to the U-Channel

Fix the bracket legs to the gypsum structure using screws.

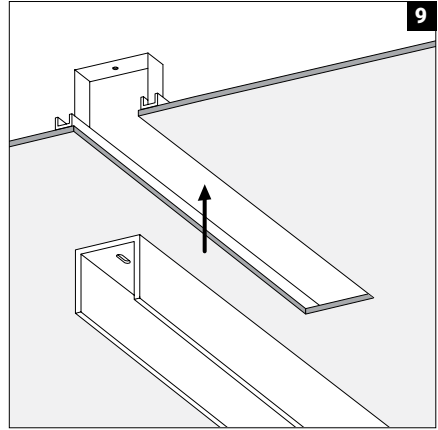

9. Placing the Luminaire Body

Insert the luminaire body into the ceiling slot.

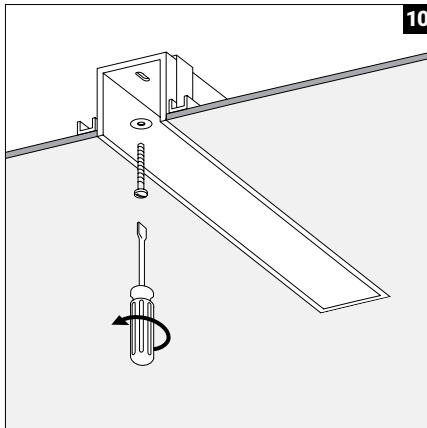

10. Fix the Luminaire Body to the U-shaped Brackets

Fix the luminaire body to the U-shaped brackets using screws.

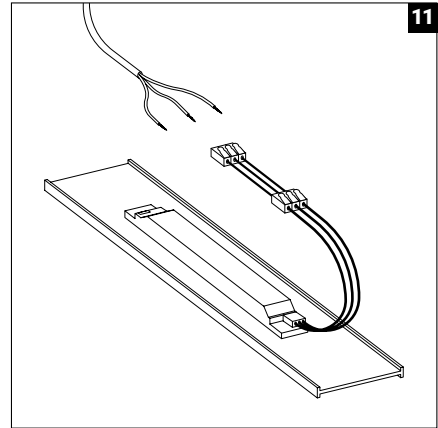

11. Connecting the Power Cable

Connect the luminaire power cable to the building power cable using a terminal block.

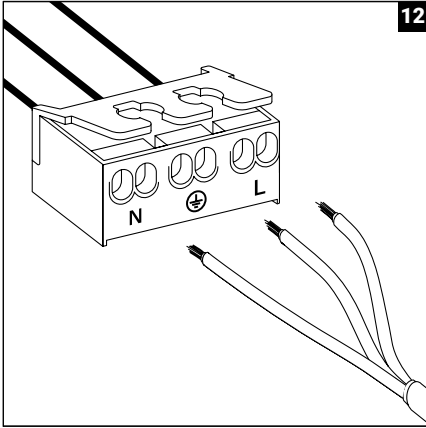

12. Connecting the Power Cable

For detailed instructions on wiring the dimmable system, refer to the relevant pages.

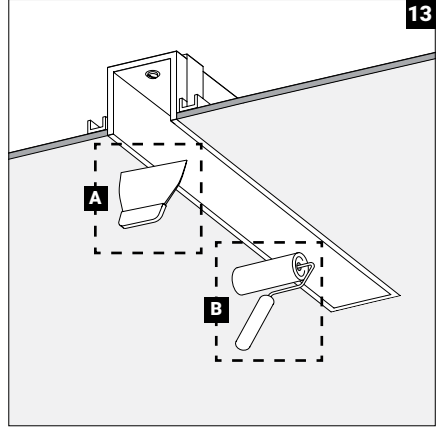

13. Filling and Painting

A: Apply filler to both sides of the luminaire body after installation.

B: Perform the final painting at the last stage.

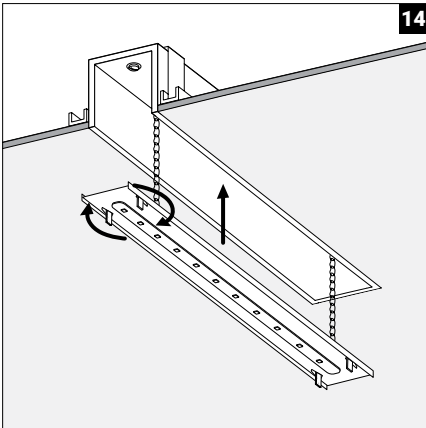

14. Reinstalling the Reflector

To install the reflector, rotate the retaining clip in the correct direction.

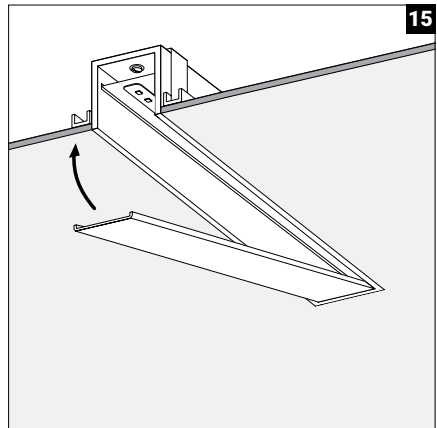

15. Installing the Diffuser

Please use a microfiber cloth to clean the diffuser.

(Microfiber cloth: nano-fiber cloth that does not leave lint and provides uniform polishing.)

DALI Dimmable System Wiring Method

For spaces equipped with smart building control protocols such as KNX, luminaires with a DALI system are recommended. They are connected to the main control system via a gateway device.

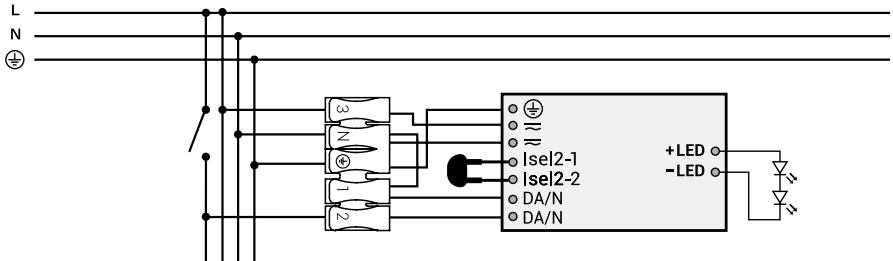
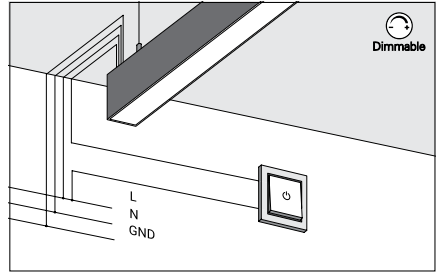

DALI Dimmable System Wiring Method

For spaces equipped with smart building control protocols such as KNX, luminaires with a DALI system are recommended. They are connected to the main control system via a gateway device.

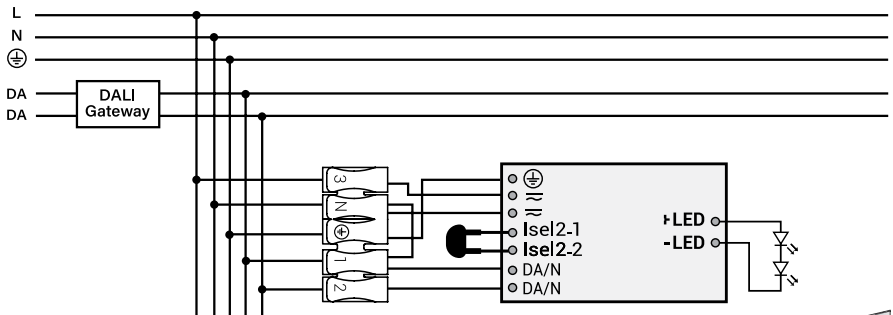
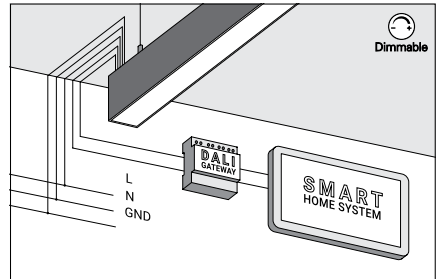

Installation Checklist

Installation Notes	1	2	3	4	5	6	7	8	9	10
1. An appropriate label is attached to the luminaire and its components, hidden from users' view. The required luminaire specifications, color temperature, and LED module wattage are indicated on the label.										
2. All wiring connections have been completed correctly, and dimmable and smart luminaires are functioning properly.										
3. The luminaires have been installed in the correct locations according to the latest approved design drawings.										
4. Pendant luminaires have been installed at the specified and appropriate height.										
5. The orientation of the luminaires and their adjustable joints is correct and aligned with the predetermined directions.										
6. The trim of recessed luminaires properly covers the ceiling or false wall cut-out, and trimless recessed luminaires have been correctly finished with filler.										
7. The mounting surface adequately supports the weight and dimensions of the luminaires, and all false ceiling connections and brackets are securely fastened.										
8. The luminaires are clean and free from scratches, dents, bending, or fingerprints. All components used, including the LED module, driver, terminal block, etc., are new.										
9. The luminaires are installed without any visible protrusions or exposed wires and cables.										
10. End caps and luminaire connections are properly secured, and there is no light leakage.										

Installation Checklist

Luminaires with Special Features	1	2	3	4	5	6	7	8	9	10
1. If the luminaires are adjustable, they have been positioned at the correct angle by a specialist according to the drawings.										
2. If the luminaires are pendant, all units are installed in a straight line and at the specified height.										
3. Square or rectangular luminaires are installed perfectly parallel to the wall lines or ceiling tiles.										
4. Wall washers distribute light uniformly across the surface.										

Luminaire Performance	1	2	3	4	5	6	7	8	9	10
1. After 12 or 24 hours of continuous operation, the luminaires function properly without flickering or partial failure.										
2. There is no light leakage from the luminaire body.										
3. luminaires are correctly connected to their sockets and holders.										

(+971) 522 56 71 07

INFO@NEXOLIGHTING.COM

NEXO_LIGHTING

WWW.NEXOLIGHTING.COM

